

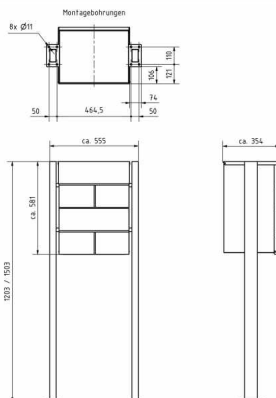

**Order number:** 303-PK-E3-9016VA-STQ  
**Manufacturer:** Briefkasten Manufaktur Lippe

ab **€554.90 \***

incl. VAT [plus shipping costs](#) (exclusive of VAT for logged-in users with VAT ID and Non-EU countries)



## Freestanding parcel box KANT Edition ST-Q - Design Elegance 3 - RAL 9016 traffic white

The free-standing KANT Edition parcel box is an innovative solution that combines **elegant design** and functional convenience. With its minimalist design, which features an invisible lock and stylish labeling options, it blends seamlessly into modern living environments. You can rely on **long-lasting quality** thanks to our excellent choice of materials and precise workmanship.

The generous opening allows parcels up to a size of 360 x 250 x 130 mm to be posted, meaning that parcels up to parcel size M can also be posted securely and without any problems. A special highlight is the protective flap, which not only elegantly covers the opening but also the lock and protects it from moisture. Thanks to the integrated airlock technology, the deposited parcels can only be removed from the bottom of the lock-secured compartment, which prevents theft by tampering from above. A parcel box for the simple receipt of parcels, parcel receipt independent of the deliverer! Any parcel delivery company (e.g. DHL, DPD, TNT, GLS, Hermes, etc.) can use this parcel box. Thanks to the airlock technology and 85 liter capacity, it is possible to receive several parcels. In addition, daily mail can be posted through the lock in the classic way.

Self-assembly is straightforward thanks to the sophisticated design.

- High-quality parcel box made of galvanized steel, powder-coated in RAL 9016 traffic white fine structure matt.
- Elegance 3 design: 2x stainless steel panel, 240 grit polished.
- Parcel compartment volume: approx. 85 liters, max. Parcel size: 360 x 250 x 130 mm (WHT), which corresponds to parcel size M.
- Large insertion flap with airlock technology for multiple parcel loading.
- Drop-in flap with damping for quiet closing.
- The door can be opened from top to bottom, providing additional protection against theft.
- Includes 2 keys with key number.
- Optional name lettering approx. 20-30 mm high.
- Optional house number lettering approx. 120-150 mm high.
- The W 40 mm x D 80 mm uprights are made of 2 mm stainless steel V2A 1.4301, 240 grain polished for setting in concrete or screw mounting.

### Important information:

In order to achieve optimum water protection for your parcels, the parcel box or parcel box system should be located under a canopy if possible.

The parcels are only protected from water if they are completely placed in the box and the flap is closed. Parcels that are not fully inserted allow moisture and dirt to enter the parcel box. Water ingress is not a reason for complaint.

### Abmessungen & Details

Number of parties:	1
Item withdrawal:	Front
Base material:	Stainless steel, Steel galvanized
Height single box in cm:	58,0
Width single box in cm:	44,0
Volume single box in liters:	85,0
Overall height in cm:	120,0   150,0
Total width in cm:	55,5
Depth in cm:	35,0
Weight in kg:	18,0
Delivery condition:	Delivery takes place in blocks, Standelemente/Paketbox geteilt
Shipping information:	Depending on the order volume, delivery is made by parcel shipment or bulky goods shipment. Partial deliveries are possible for products that can be disassembled (e.g., for floor-standing mailboxes, the stand & box can be shipped separately).