

Order number: 303-A1-9007VA-STQ

Manufacturer: Briefkasten Manufaktur Lippe

ab **€254.90 ***

incl. VAT [plus shipping costs](#) (exclusive of VAT for logged-in users with VAT ID and Non-EU countries)

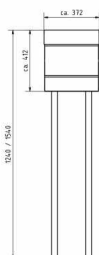
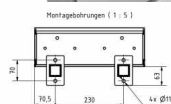
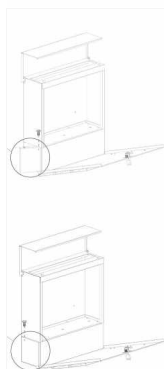
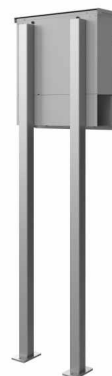

Free-standing letterbox KANT with newspaper compartment - Design Avantgarde 1 - RAL 9007 gray aluminum

The free-standing letterbox KANT Avantgarde combines **elegant design** and functional convenience in one product. Its minimalist design with invisible lock and stylish labeling option fits seamlessly into modern living environments. You can rely on **long-lasting quality** thanks to our excellent choice of materials and precise workmanship.

The generous capacity of around 12 liters and top-loading ensures crease-free mail - even with DIN C4 envelopes and magazines. For added convenience, the letterbox is equipped with **high-quality axle dampers** that allow the flap to close gently and quietly. The newspaper compartment of this letter box offers maximum functionality with double-sided accessibility, ideal for modern everyday life. The scope of delivery includes a cover that can be retrofitted, giving you the option of reliably closing the weather side.

Thanks to the design, self-assembly is uncomplicated.

- High-quality manufactured free-standing letterbox with letterbox made of galvanized steel, powder-coated in RAL 9007 grey aluminium fine structure matt.
- Design Avantgarde 1: 1x stainless steel panel, polished in 240 grit with street name and house number, 1x name plate, polished in 240 grit.
- The door can be opened from top to bottom.
- Insertion from above, insertion flap with high-quality axle dampers for silent closing.
- Includes 2 keys with key number.
- The letterbox complies with DIN/EN 13724. Insertion size (3.5 cm x 33.5 cm) for C4 landscape, large letters also fit in here without creasing.
- Newspaper compartment (BH 360x110mm), open on both sides (1x cover included).
- Optional name lettering approx. 8-25mm high.
- Optional street name approx. 8-25mm high.
- Optional house number lettering approx. 60-80mm high.
- The pedestals are made of 40 mm x 40 mm stainless steel V2A 1.4301, ground for setting in concrete or screw mounting.

Important information:

To achieve optimum water protection for your mail, the letterbox or letterbox system should be located under a canopy if possible. The mail is only protected from water if it is completely placed in the box and the flap is closed. Mail that is not fully inserted allows moisture and dirt to enter the letterbox. This system is protected against the ingress of water in accordance with DIN EN 13724. Water ingress is not a reason for complaint.

Abmessungen & Details

| | |
|--------------------------------|--|
| Number of parties: | 1 |
| Item withdrawal: | Front |
| Base material: | Steel galvanized, Stainless steel |
| Height single box in cm: | BK 28,0 ZF 11,0 |
| Width single box in cm: | 35,5 |
| Volume single box in liters: | 12,0 |
| Height letter slot in cm: | 3,5 |
| Width letter slot in cm: | 33,5 |
| Height letterbox system in cm: | 41,2 |
| Width letterbox system in cm: | 37,2 |
| Overall height in cm: | 120,0 150,0 |
| Depth in cm: | 11,0 + 2,1 Blende + 4,0 Standelemente |
| Weight in kg: | 14,0 |
| Delivery condition: | Delivery takes place in blocks, Stand elements/letterbox divided |
| Shipping information: | Depending on the order volume, delivery is made by parcel shipment or bulky goods shipment. Partial deliveries are possible for products that can be disassembled (e.g., for floor-standing mailboxes, the stand & box can be shipped separately). |