

Order number: 810-1-W-7016-100

Manufacturer: Briefkasten Manufaktur Lippe

ab **€309.00 ***

incl. VAT [plus shipping costs](#) (exclusive of VAT for logged-in users with VAT ID and Non-EU countries)

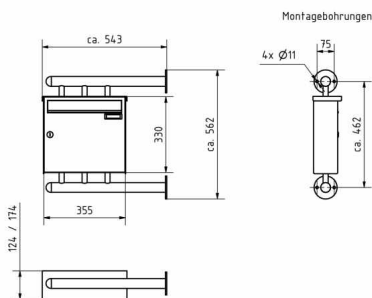

Mailbox BASIC 810 W for side wall mounting - RAL 7016 anthracite gray

This mailbox combines the highest quality and modern design. The mailbox is made of galvanized steel, powder coated in anthracite gray RAL 7016 fine structure, matt. Extremely high quality workmanship and the sophisticated concept make this free-standing letterbox our top seller. A rain drainage edge for optimal water protection, a continuous rubber lip for quiet insertion and the very robust change name plate characterize this mailbox.

Thanks to the construction method, self-assembly is uncomplicated.

The letterbox is made by the letterbox manufactory. 100% Made in Germany, Bad Salzuflen.

- Mailbox made of galvanized steel, powder coated in anthracite gray RAL 7016 fine structure, matt.
- The removal doors open from left to right with rain drainage edge for optimal water protection.
- Insertion flap with noise-damping rubber seal for very quiet insertion of mail.
- With changeable name plate and 2 keys.
- The mailbox complies with DIN EN 13724. Insert size (3.5 cm x 32.5 cm) for DIN C4 landscape, here fit even large letters without bending.
- The mounting columns are made of 42.4 mm stainless steel V2A 1.4301, ground for screw mounting on the house wall.

Important information:

Mail is protected from moisture and dirt only when fully inserted and the flap is closed. In certain extreme weather conditions, water can still enter (according to DIN EN 13724 up to 1cm). This is not a reason for complaint.

Abmessungen & Details

Number of parties:	1
Item withdrawal:	Front
Height single box in cm:	33,0
Width single box in cm:	35,5
Volume single box in liters:	12,0 17,0
Height letter slot in cm:	3,5
Width letter slot in cm:	32,5
Height letterbox system in cm:	33,0
Width letterbox system in cm:	35,5
Depth in cm:	10,0 15,0
Weight in kg:	12,0
Shipping information:	Depending on the order volume, delivery is made by parcel shipment or bulky goods shipment. Partial deliveries are possible for products that can be disassembled (e.g., for floor-standing mailboxes, the stand & box can be shipped separately).