

Order number: 523BR-VAR
Manufacturer: Briefkasten Manufaktur Lippe

ab **€832.00 ***

incl. VAT [plus shipping costs](#) (exclusive of VAT for logged-in users with VAT ID and Non-EU countries)

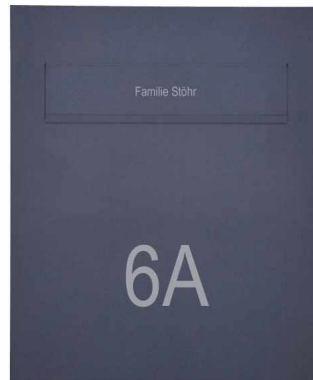
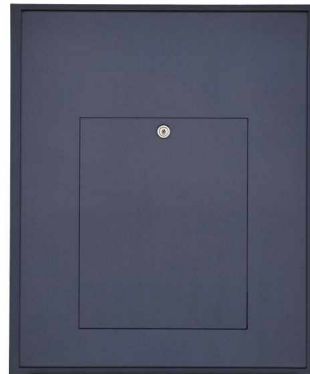
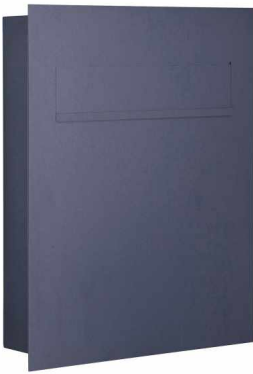

Eingebaute Dämpfungselemente lassen die Einwurflappe langsam und leise schließen

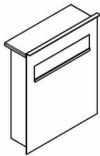
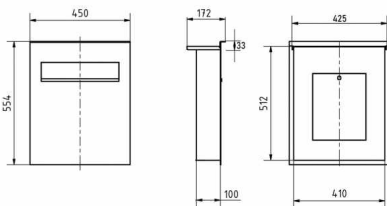

Regendach "DESIGNER" (nicht bei Regenmontage)

Für Aufputz-, Zaun- und Standbriefkästen der Kollektion Designer liegt ein Regendach bei. Dieses ist selbstklebend und nach erfolgreicher Montage oben auf dem Briefkasten aufzusetzen. Achten Sie dabei auf eine genaue Ausrichtung!



Stainless steel design fence letter box DESIGNER Style BIG powder-coated - removal at the back

High-quality manufactured stainless steel letterbox with powder coating in RAL or DB colour of the brand Briefkasten Manufaktur in extra large format. A real eye-catcher among the letterboxes. Clear lines and sleek design distinguish this designer letterbox. The letterbox is inserted from the front, the residents can remove the mail from the back. Our products have a high quality, reliable functionality and their own identity. Made by Briefkasten Manufaktur.

- Designer stainless steel fence mailbox made of 2 mm stainless steel V2A, powder-coated, textured matt.
- No visible screw connection or rivets.
- Rear-side mail removal opening 240 mm x 300 mm, to be opened from top to bottom. Incl. 2 keys with key number.
- Post insertion from the front, dimensions insertion: W 35 cm x H 6.3 cm, C4 landscape. Very large letters fit in here without bending. Attention: no removal protection!
- **With immediate effect with built-in damping elements, these allow the insertion flap to close slowly and quietly**
- Dimensions front panel: W 45 cm x H 55 cm x D 0.2 cm. ATTENTION: the front panel protrudes 2 cm all around.
- Dimensions of rear frame: H 510 mm x W 410 x D 100 without perforation. The perforation for fastening must be provided by the customer.
- Optional name inscription, lasered approx. 10mm high.
- Optional house number inscription, lasered approx. 100mm high.
- Inside water protection plate. Close-fitting rain sheet enclosed.
- Corpus without mounting holes (must be done on site!), optionally with mounting for bar mat fence.
- Incl. assembly aid.

Water protection

In order to achieve optimum water protection for your mail, the letterbox or letterbox system should, if possible, be located under a canopy.

The mail item should be placed under a canopy.

The mail is only protected from water when it is completely deposited in the box and the access flap is closed. Mail that is not fully inserted allows moisture and dirt to penetrate the letterbox. It is therefore necessary to plan sufficiently dimensioned letterboxes for the upcoming demand. In certain extreme weather conditions, water may nevertheless enter (according to DIN EN 13724 up to 1ccm). This is not a reason for complaint.

Abmessungen & Details

Number of parties:	1
Item withdrawal:	Back
Base material:	Stainless steel
Height single box in cm:	51,0 55,0
Width single box in cm:	41,0 45,0
Volume single box in liters:	21,0 31,0
Height letter slot in cm:	6,5
Width letter slot in cm:	35,0
Depth in cm:	10,0
Weight in kg:	16,0
Delivery condition:	Delivery is completely assembled
Shipping information:	Depending on the order volume, delivery is made by parcel shipment or bulky goods shipment. Partial deliveries are possible for products that can be disassembled (e.g., for floor-standing mailboxes, the stand & box can be shipped separately).