



Order number: 155-7016

Manufacturer: Briefkasten Manufaktur Lippe

ab **€79.90 ***

incl. VAT [plus shipping costs](#) (exclusive of VAT for logged-in users with VAT ID and Non-EU countries)

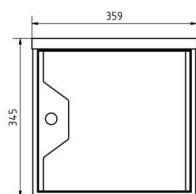

Design mailbox HESSE 155-7016 with newspaper compartment - RAL 7016 anthracite gray

The price-performance winner! Our top seller & a real all-rounder. This mailbox is an exclusive product, only available from us. Now in anthracite gray in a modern minimalist design.

The dimensions allow a capacity of about 12 liters, the insertion from the top guarantees even with DIN C4 envelopes and magazines or after several days of absence no crumpled mail. With the lock on the left side, this wall mailbox is designed to keep your hands free when opening it, and the practical retaining bracket prevents mail from falling towards you. Due to the insertion from the top, the mail inside is optimally protected from the weather. The mailbox is weatherproof and waterproof. The lid is secured with rubber buffers against annoying rattling. The newspaper compartment is discreetly hidden in the removal door and can be occupied from the left and right, due to the convenient size here can also accommodate large weekly papers. The high-quality processed mailbox with newspaper compartment is made entirely of steel, galvanized & powder coated, there are no visible welding points or rivets.

- Mailbox made of galvanized sheet steel, powder coated in RAL 7016 anthracite gray fine structure, matt.
- With integrated newspaper compartment in the removal door, open on both sides.
- Large capacity, convenient insertion from above.
- Door opens from left to right incl. 2 keys.
- With mail holding bracket, so that the mail does not fall towards you.
- The box complies with DIN/EN, insertion C4 crosswise. Here fit even large letters without bending.
- Incl. self-adhesive engravable nameplate made of stainless steel.
- Optional name inscription, lasered approx. 8-10mm high.
- Optional house number inscription, lasered approx. 80-100mm high.
- Incl. mounting material for wall mounting. Optionally with rod mat holder for fence mounting.

Abmessungen & Details

Number of parties:	1
Item withdrawal:	Front
Base material:	Steel galvanized
Height single box in cm:	34,6
Width single box in cm:	35,5
Volume single box in liters:	12,0
Height letter slot in cm:	3,4
Width letter slot in cm:	32,7
Depth in cm:	10.0 + 6.0 Newspaper compartment
Weight in kg:	5,0
Delivery condition:	Delivery is completely assembled
Shipping information:	Depending on the order volume, delivery is made by parcel shipment or bulky goods shipment. Partial deliveries are possible for products that can be disassembled (e.g., for floor-standing mailboxes, the stand & box can be shipped separately).