

Order number: 651X-VA-DEKVA

Manufacturer: Briefkasten Manufaktur Lippe

ab **€639.00 ***

incl. VAT [plus shipping costs](#) (exclusive of VAT for logged-in users with VAT ID and Non-EU countries)

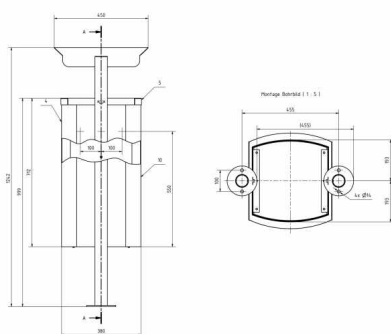

Waste bin - Design BASIC 651X waste bin with rain cover - 65 litres - polished stainless steel

High-quality manufactured litter bin with elegant round tube stand elements & rain roof. The free-standing litter bin is made entirely of 2mm stainless steel V2A 1.4301, polished. This litter bin spares no comparison, extremely high quality workmanship and precision. The dimensions allow a capacity of approx. 65 litres, the opening guarantees the convenient insertion of waste. Due to the well thought-out waste bag removal (see video), the waste bin is constructed without visible screw connections and rivets.

Thanks to the construction, the waste bin can be emptied easily.

Thanks to the construction method, self-assembly is uncomplicated.

- Waste bin - waste bin made of stainless steel V2A 1.4301, 240 grain ground.
- The litter bin is created at Briefkasten Manufaktur. German quality manufacturing "Made in Germany".
- Lid plate optionally made of stainless steel V2A 1.4301, 240 grain ground or stainless steel V2A, powder coated according to RAL colour.
- Capacity of approx. 65 litres, the opening to the top (320mm x 320mm) guarantees the convenient insertion of waste.
- Simple and easy changing of the plastic bag: unlock and remove the cover plate, remove the front plate, change the plastic bag.
- Rain roof made of 2mm stainless steel, ground.
- Water drainage corners in the bottom prevent water accumulation in the container.
- Optional pictograms/labelling possible.
- The pedestals are made of 60.3 mm stainless steel V2A 1.4301, ground for screw mounting or for setting in concrete.

Abmessungen & Details

Base material:	Stainless steel
Volume single box in liters:	65,0
Overall height in cm:	120,0
Total width in cm:	51,5
Depth in cm:	38,0
Weight in kg:	30,0
Delivery condition:	Delivery in blocks, stand elements/corpus divided
Shipping information:	Depending on the order volume, delivery is made by parcel shipment or bulky goods shipment. Partial deliveries are possible for products that can be disassembled (e.g., for floor-standing mailboxes, the stand & box can be shipped separately).