



Order number: 789-E-2T-VA

Manufacturer: Briefkasten Manufaktur Lippe

ab **€39.00 ***

incl. VAT [plus shipping costs](#) (exclusive of VAT for logged-in users with VAT ID and Non-EU countries)

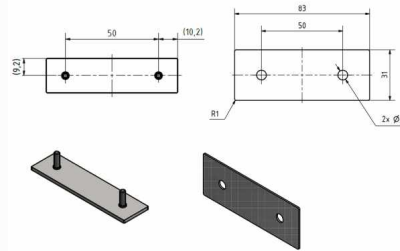

Flush-mounted name plate for BASIC letterbox - 2-piece - support plate + name plate optionally with laser inscription

This name plate can be exchanged for the plastic name plate of the BASIC letterboxes. The flush-fitting appearance makes the letterbox look much more elegant and modern with this name plate. The name plate is made of stainless steel V2A 1.4301 and can optionally be powder-coated. The name plate is made of 2 parts, consisting of a carrier plate (self-adhesive) and the name plate for screwing. This guarantees that the name badge can be easily replaced if there is a change of tenant.

- Name plate made of 2mm stainless steel V2A 1.4301, ground or powder-coated.
- Consisting of carrier plate and name plate. The carrier plate is self-adhesive and is glued in on the back for mounting.
- Optionally with laser inscription. The size of the lettering is adapted to the space available and the number of characters.

Abmessungen & Details

Base material: Stainless steel

Height in cm: 1,8

Width in cm: 7,0

Depth in cm: 0,2