



Order number: 205ITB-B

Manufacturer: Briefkasten Manufaktur Lippe

ab **€299.00 ***

incl. VAT [plus shipping costs](#) (exclusive of VAT for logged-in users with VAT ID and Non-EU countries)

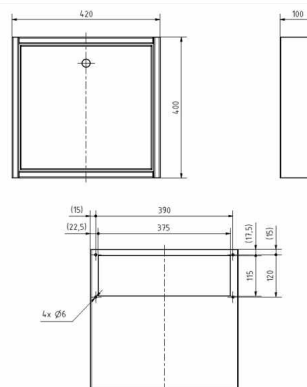
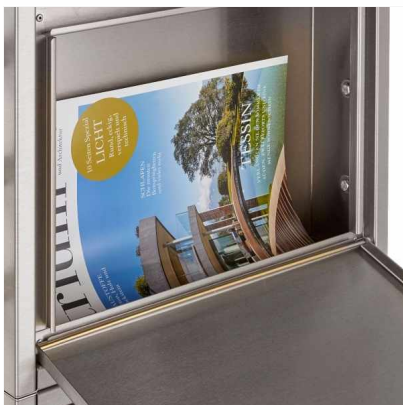

Stainless steel interior door letterbox BIG - Suitable for letter slot 410x140mm

High-quality interior door letterbox completely made of 1.5 mm stainless steel V2A 1.4301, ground. The insertion is on the front side, the residents can remove the mail from the back. The letterbox can be integrated into any wall in combination with the letter slot 555 (410x140mm), which does not exceed a thickness of 20mm. The installation of the system is very simple and is done with 4 screws.

The dimensions allow for a capacity of approx. 16 litres, the large slot guarantees no crumpled mail even with DIN C4 envelopes and magazines or after several days of absence. With the lock on top, this letterbox is designed so that the removal door prevents mail from falling towards you. This letterbox spares no comparison, extremely high quality workmanship and precision. Every component including the walls and interior parts of this letterbox are made of stainless steel V2 A, polished.

- Inside door letterbox made of 1.5 mm stainless steel V2A 1.4301, ground.
- Quality manufacturing - Made in Germany.
- Optimal rain protection due to rain protection edge and water protection plate inside.
- Stainless steel cylinder lock; with dust protection flap & 2 keys.
- Opening door from top to bottom. So the mail cannot fall towards you.
- Fits letter trays: 555-BE-35, 555-BE-35-VAR

Important information:

The mail is only protected from water when it is completely deposited in the box and the insertion flap is closed. Mail that is not completely inserted allows moisture and dirt to penetrate the letterbox. It is therefore necessary to plan sufficiently dimensioned letterboxes for the upcoming demand. In certain extreme weather conditions, water may nevertheless enter (according to DIN EN 13724 up to 1ccm). This is not a reason for complaint.

Abmessungen & Details

Number of parties:	1
Item withdrawal:	Front
Base material:	Stainless steel
Height single box in cm:	40,0
Width single box in cm:	42,0
Volume single box in liters:	16,0
Depth in cm:	10,0
Weight in kg:	7,0
Delivery condition:	Delivery is assembled
Shipping information:	Depending on the order volume, delivery is made by parcel shipment or bulky goods shipment. Partial deliveries are possible for products that can be disassembled (e.g., for floor-standing mailboxes, the stand & box can be shipped separately).