

Order number: 670X2-VA-4FACH

Manufacturer: Briefkasten Manufaktur Lippe

ab **€1,299.00 ***

incl. VAT [plus shipping costs](#) (exclusive of VAT for logged-in users with VAT ID and Non-EU countries)

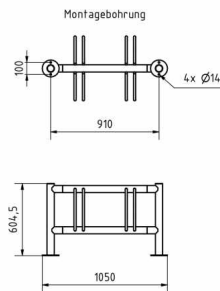
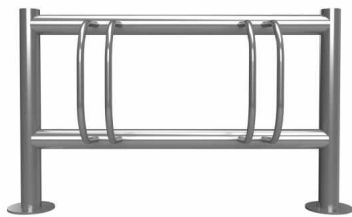

ACHIM bicycle stand - polished stainless steel V2A - double-sided wheel setting

The noble bicycle stand ACHIM for the double-sided wheel setting with curved holding brackets arouses an organic appearance by the round forms, which fits into each modern arranged environment. The bike stand is completely made of stainless steel V2A 1.4301 ground and available in 4 different sizes. Material and workmanship are characterized by the highest quality. Durable weather resistance and absolute robustness against high mechanical loads are a matter of course for this multiple stand for bicycles. In addition, the bicycle stand ACHIM allows theft-proof parking of bicycles, as all components are welded.

- Bicycle stand completely made of stainless steel V2A 1.4301, 240 grain ground.
- The bike stand is made at the mailbox manufactory. German quality production "Made in Germany".
- Suitable for double-sided wheel setting.
- Tire width 60 mm.
- Wheel distance 430 mm.
- Adjustment angle 90°.
- Stainless steel stirrup made of Ø 15 mm round steel, 240 grain ground.
- The columns and crossbars are made of 60.3 mm stainless steel V2A 1.4301, 240 grain polished, either for screw mounting or for setting in concrete.

Abmessungen & Details

Base material: Stainless steel

Overall height in cm: 60,5

Total width in cm: 97.0 | 140.0 | 183.0 | 226.0 (without footplate)

Depth in cm: 54,2

Weight in kg: 25,0 - 75,0

Delivery condition: Delivery is assembled

Shipping information: Delivery by forwarding agent on one-way pallet. Before delivery, the forwarding agent will contact you by phone to arrange the date.