



Order number: 215-STK-200600

Note: After your order you will receive a proof to adjust the position of the inserts according to your needs.

Manufacturer: Briefkasten Manufaktur Lippe

ab **€496.00 ***

incl. VAT [plus shipping costs](#) (exclusive of VAT for logged-in users with VAT ID and Non-EU countries)

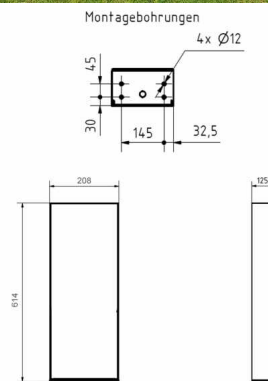
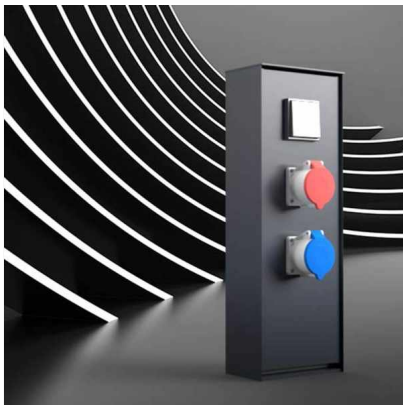

Design socket column GOETHE 200x600 for floor mounting - RAL of your choice

The modern GOETHE socket column is ideal for sophisticated areas. The linear design makes this socket column look particularly elegant. This socket column is absolutely weatherproof due to the 3mm side cladding with rain cover and the rear wall with base plate made of 6mm aluminum, as well as with the IP44 sockets (CEE, Schuko) and perfectly suitable for outdoor use.

- High quality socket column made of stainless steel and aluminium.
- Quality manufacturing - Made in Germany by Briefkasten Manufaktur Lippe.
- Body (WxHxD 200 x 600 x 100 mm) made of stainless steel 1.4016 (non-rusting magnetic stainless steel), powder coated in RAL of your choice.
- Function box can be opened from top to bottom. Non-visible fastening with screws.
- Optimal rain protection by rain protection edges and a rain canopy made of 3mm aluminum AlMg3 W19, powder coated in RAL of your choice.
- Side panel made of 3mm aluminum AlMg3 W19, powder coated in RAL of your choice.
- Rear panel and base plate made of 6mm aluminum AlMg3 W19, powder-coated in RAL of your choice.
- Invisible mounting in the socket column due to reinforced base plate.

Important information

According to DIN VDE 0100-708 regulation, only up to a maximum of 4 sockets per energy column may be installed.

Abmessungen & Details

Base material: Stainless steel, Aluminum

Overall height in cm: 61,4

Total width in cm: 20,8

Depth in cm: 10.0 + 2.5 Rain roof

Weight in kg: 11,0

Delivery condition: Delivery is assembled

Shipping information: Depending on the order volume, delivery is made by parcel shipment or bulky goods shipment. Partial deliveries are possible for products that can be disassembled (e.g., for floor-standing mailboxes, the stand & box can be shipped separately).