

3-piece stainless steel surface-mounted letterbox system Design BASIC Plus 385XA AP - RAL of your choice | 300x110x385 mm (WxHxD) - ?? Normal 12 litres | ? Colour of your choice | with 3 letterboxes (1x3)

Product number 385XA-3S



Product description

3-post stainless steel surface-mounted letterbox system Design BASIC Plus 385XA AP - RAL of your choice

Modern surface-mounted letterbox system for 3 parties made in Germany by Briefkasten Manufaktur.

The letterboxes are made of stainless steel V2A, powder-coated in RAL colour. This letterbox system is characterised by close-fitting side cladding with rain canopy and rain drainage channels for optimum water protection, a throw-in flap with rubber lip, the solid interchangeable nameplate and the robust lock. This letterbox is easy to clean and robust.

The letterbox systems in the BASIC Plus collection are characterised by the consistent use of V2A stainless steel. The result is a very long service life and sustainability. The design has been developed by our own engineers with a view to high flexibility and modularity, simple spare parts assembly and uncomplicated self-assembly. Spare parts are directly available for all BASIC Plus systems.

- **3-piece surface-mounted letterbox system completely powder-coated in RAL colour.**
- The system is manufactured by Briefkasten Manufaktur. German quality production "Made in Germany".
- The letterboxes made of stainless steel V2A, powder-coated in RAL colour, comply with DIN/EN 13724. Insertion size (3.5 cm x 26.5 cm) for C4 high, even large letters fit in here without creasing.
- Insertion flaps with sound-absorbing rubber lip for very quiet insertion of mail.
- The doors can be opened from left to right.
- Incl. 2 keys with key number and changeable name plate under the flap for each letterbox.
- With close-fitting side panelling and rain cover in solid design.
- For easy 1-2 person wall mounting with mounting rail incl. fixing material (screws + wall plugs).

Important information:

The post is only protected from moisture and dirt when it is fully inserted and the flap is closed. Under certain extreme weather conditions, water can still enter (up to 1cm according to DIN EN 13724). This is not a reason for complaint.

Product properties

Surface/colour	RAL 9005 deep black, RAL 3004 crimson red, DB 703 iron mica, RAL 7016 anthracite grey, RAL of your choice (according to colour table), RAL 9007 grey aluminium, RAL 9016 traffic white
Series	BASIC
Boxes by volume	Normal > 10 litres
Name labelling	Nameplate
Material	Stainless steel V2A 1.4301
Removal of mail	On the front
Mounting type	Surface-mounted
Number of letterboxes	with 3 letterboxes

Dimensions

Height of single box in mm	110,0
Width of single box in mm	300,0
Capacity in litres	12
Height of letterbox slot in mm	35,0
Width of letter slot in mm	265,0
Height of letterbox in mm	330,0
Width of letterbox system in mm	300,0
Total width in mm	308,0
Depth in mm	435,0
Weight in kg	20
Delivery condition	Supplied fully assembled

Drawing

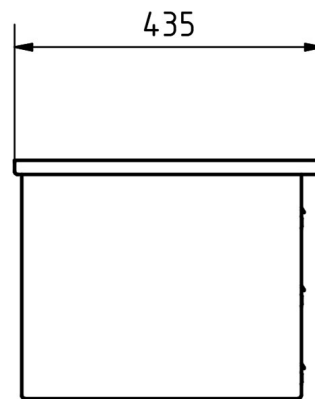
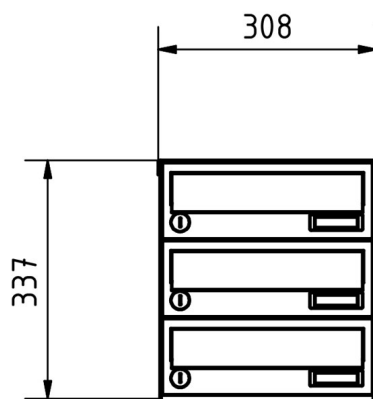

More images

