

# 3-piece surface-mounted letterbox system Design BASIC 385A- VA AP - stainless steel V2A, polished | 300x110x385 mm (WxHxD) - ?? Normal 12 litres | Stainless steel, ground | with 3 letterboxes (1x3)

Product number 385A-VA-3S

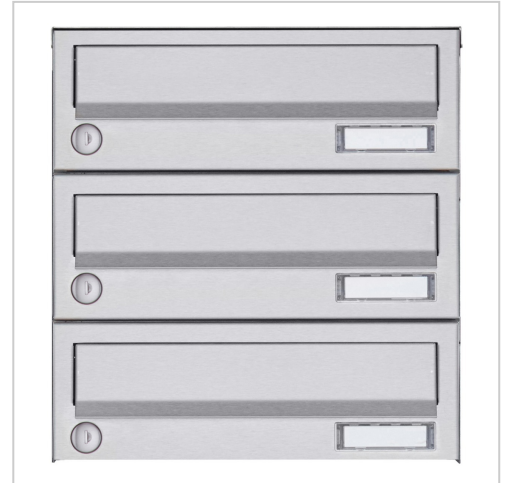

## Product description

### 3-point surface-mounted letterbox system made of stainless steel V2 A polished - Design BASIC 385A-VA incl. side panelling & rain cover - horizontal letterboxes

Modern surface-mounted letterbox system for 3 parties made in Germany by Briefkasten Manufaktur.

The letterbox system is made entirely of stainless steel V2A, polished. This letterbox system is characterised by a close-fitting side cladding with rain canopy and the rain drainage channels for optimum water protection, a throw-in flap with rubber lip, the solid interchangeable nameplate and the robust lock. This letterbox is easy to clean and robust.

Thanks to the design, self-assembly is uncomplicated.

- **3-post surface-mounted letterbox system made entirely of V2A stainless steel, polished**
- The system is manufactured by Briefkasten Manufaktur. German quality production "Made in Germany".
- The letterboxes made of V2A stainless steel, polished, comply with DIN/EN 13724. Insertion size (3.5 cm x 26.5 cm) for C4 high, large letters also fit in here without creasing.
- Insertion flaps with sound-absorbing rubber lip for very quiet mail insertion.
- The doors can be opened from left to right.
- Incl. 2 keys with key number and changeable name plate under the flap for each letterbox.
- Incl. close-fitting side panelling + rain cover made of V2A stainless steel, polished.
- For easy 1-2 person wall mounting with mounting rail incl. fixing material (screws + dowels).

#### Important information:

The post is only protected from moisture and dirt when it is fully inserted and the flap is closed. Under certain extreme weather conditions, water can still enter (up to 1ccm according to DIN EN 13724). This is not a reason for complaint.

## Product properties

|                 |                            |
|-----------------|----------------------------|
| Series          | BASIC                      |
| Boxes by volume | Normal > 10 litres         |
| Name labelling  | Nameplate                  |
| Material        | Stainless steel V2A 1.4301 |
| Removal of mail | On the front               |
| Surface/colour  | Brushed                    |
| Mounting type   | Surface-mounted            |
| Number of boxes | with 3 letterboxes         |

## Dimensions

|                                 |                          |
|---------------------------------|--------------------------|
| Height of single box in mm      | 110,0                    |
| Width of single box in mm       | 300,0                    |
| Capacity in litres              | 12                       |
| Height of letterbox slot in mm  | 35,0                     |
| Width of letter slot in mm      | 265,0                    |
| Height of letterbox in mm       | 330,0                    |
| Width of letterbox system in mm | 300,0                    |
| Total width in mm               | 308,0                    |
| Depth in mm                     | 435,0                    |
| Weight in kg                    | 20                       |
| Delivery condition              | Supplied fully assembled |

## Drawing

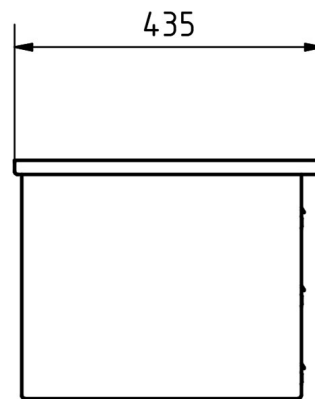
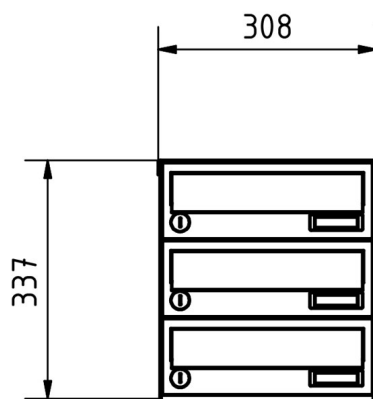

## More images

