

# Design surface-mounted letterbox GRIMM - colour of your choice | ? Colour of your choice | Surface-mounted

Product number 562-AP-1-SF



## Product description

### Design letterbox GRIMM® - A masterpiece of letterbox manufacturing

The GRIMM® designer letterbox is the perfect eye-catcher for any entrance area. With clear lines and a no-frills design, this letterbox is impressive across the board. Developed with over 21 years of experience in letterbox construction, the GRIMM® combines the best of our DESIGNER and GOETHE® collections. The flush-mounted look of the DESIGNER letterbox meets state-of-the-art locking technology and optimum weather protection, as found in the GOETHE® collection.

The GRIMM® letterbox is not only a visual highlight, but also at the forefront in terms of functionality and quality. Thanks to the innovative push-key lock, the letterbox can be operated easily and conveniently with one hand. Open the door with one push and close the door without using a key. The lock is optimally protected from the weather. The letterbox also features an intelligent removal system: the door opens from top to bottom, ensuring that the mail remains securely in the box and cannot fall towards you. Mail is also conveniently inserted from the front, with high-quality axle dampers ensuring that the flap closes gently. The GRIMM is particularly unique thanks to its double box system: the surface-mounted body made of powder-coated stainless steel V2A (#####) is installed first, while the cover can be inserted once the installation work is complete. The offset cover also offers optimum protection against rain and other environmental influences.

Thanks to the DIN/EN 13724 standard, the GRIMM is ideal for large letters in C4 format, which can be inserted without creasing. The GRIMM® letterbox impresses with its durable quality, timeless design and sophisticated functionality.

- High-quality letterbox made entirely of stainless steel for surface mounting.
- Front panel made of 2 mm stainless steel V2A 1.4301, powder-coated.
- Quality production - Made in Germany by Briefkasten Manufaktur Lippe.
- Innovative push-key lock including 2 keys with key number, convenient locking without key, optimally protected from the weather.
- The removal door with opening limiter opens from top to bottom to prevent mail from falling towards you.
- Front insertion with high-quality axle dampers for very quiet mail insertion.
- DIN/EN 13724-compliant letterbox, insertion size (3.5 cm x 32.5 cm) for C4 landscape - even large letters remain intact. Additional stainless steel removal protection integrated.
- Optimum weather protection thanks to offset cover.
- Optional name labelling approx. 15-20 mm high.
- Optional house number lettering approx. 70-80mm high.
- Double box system: Ideal for surface mounting. The cover can be easily installed once the construction work is complete.
- Surface-mounted box made of 2mm stainless steel V2A 1.4301, powder-coated.

### Important information:

To achieve optimum water protection for your mail, the letterbox or letterbox system should be located under a canopy if possible.

The mail is only protected from water if it is fully inserted in the box and the flap is closed. Mail that is not fully inserted allows moisture and dirt to enter the letterbox. This system is protected against the ingress of water in accordance with DIN EN 13724. Water ingress is not a reason for complaint.

## Product properties

<b>Surface/colour</b>	RAL 9005 deep black, RAL 3004 crimson red, DB 703 iron mica, RAL 7016 anthracite grey, RAL of your choice (according to colour table), RAL 9007 grey aluminium, RAL 9016 traffic white
<b>Series</b>	GRIMM
<b>Material</b>	Stainless steel V2A 1.4301, Stainless steel 1.4016 (non-rusting magnetic stainless steel)
<b>House number</b>	House number as laser engraving
<b>Name labelling</b>	Laser-engraved
<b>Removal of mail</b>	On the front
<b>Number of boxes</b>	with 1 letterbox
<b>Boxes by volume</b>	Large > 16 litres
<b>Mounting type</b>	Flush-mounted

## Dimensions

<b>Height of single box in mm</b>	460,0
<b>Width of single box in mm</b>	410,0
<b>Capacity in litres</b>	26,0
<b>Height of letterbox slot in mm</b>	35,0
<b>Width of letter slot in mm</b>	325,0
<b>Height of letterbox in mm</b>	510,0
<b>Width of letterbox system in mm</b>	460,0
<b>Depth in mm</b>	155,0
<b>Weight in kg</b>	26
<b>Delivery condition</b>	Delivery is assembled

## Drawing

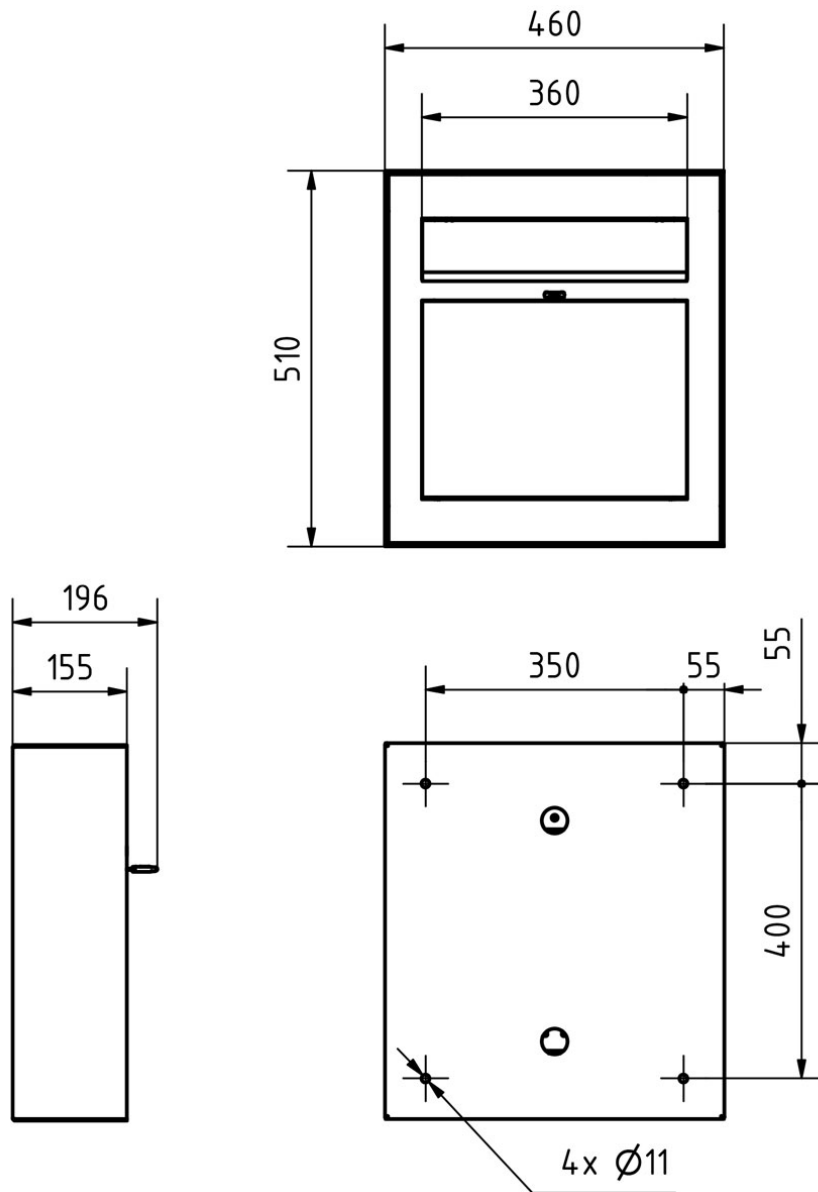

## More images



