

2-piece surface-mounted letterbox system Design BASIC 385A-9016 AP - RAL 9016 traffic white | RAL 9016 traffic white fine structure matt | 300x110x385 mm (WxHxD) - ?? Normal 12 litres | with 2 letterboxes (1x2)

Product number 385A-9016-2S

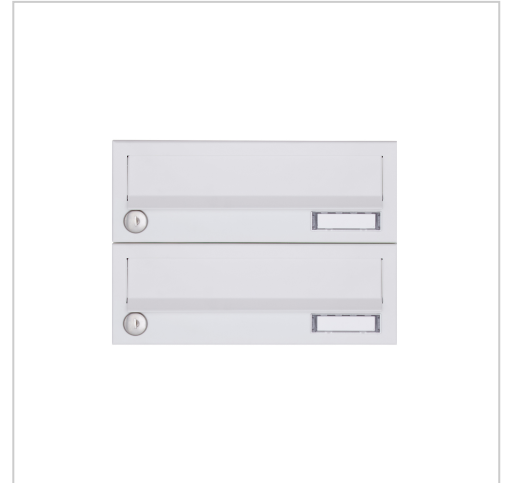

Product description

2-post surface-mounted letterbox system Design BASIC 385A-9016 AP - RAL 9016 traffic white

Modern surface-mounted letterbox system for 2 parties made in Germany by Briefkasten Manufaktur.

The letterboxes are made of galvanised steel, powder-coated in RAL 9016 traffic white. This letterbox system is characterised by a close-fitting side cladding with rain canopy and rain drainage channels for optimum water protection, a throw-in flap with rubber lip, the solid interchangeable nameplate and the robust lock. This letterbox is easy to clean and robust.

Thanks to the design, self-assembly is uncomplicated.

- **2-post surface-mounted letterbox system completely powder-coated in RAL 9016 traffic white fine structure matt**
- The system is manufactured by Briefkasten Manufaktur. German quality production "Made in Germany".
- The letterboxes made of galvanised steel, powder-coated in RAL 9016 traffic white fine structure matt, comply with DIN/EN 13724. Insertion size (3.5 cm x 26.5 cm) for C4 high, large letters also fit in here without creasing.
- Insertion flaps with sound-absorbing rubber lip for very quiet mail insertion.
- The doors can be opened from left to right.
- Incl. 2 keys with key number and changeable name plate under the flap for each letterbox.
- With close-fitting side panelling and rain cover in solid design.
- For easy 1-2 person wall mounting with mounting rail incl. fixing material (screws + wall plugs).

Important information:

The post is only protected from moisture and dirt when it is fully inserted and the flap is closed. Under certain extreme weather conditions, water may still enter (up to 1ccm according to DIN EN 13724). This is not a reason for complaint.

Product properties

Material	Steel, galvanised
Series	BASIC
Boxes by volume	Normal > 10 litres
Name labelling	Nameplate
Number of boxes	with 2 letterboxes
Removal of mail	On the front
Mounting type	Surface-mounted
Surface/colour	RAL 9016 traffic white

Dimensions

Height of single box in mm	110,0
Width of single box in mm	300,0
Capacity in litres	12
Height of letterbox slot in mm	35,0
Width of letter slot in mm	265,0
Height of letterbox in mm	220,0
Width of letterbox system in mm	300,0
Total width in mm	465,0
Depth in mm	435,0
Weight in kg	15
Delivery condition	Supplied fully assembled

Drawing

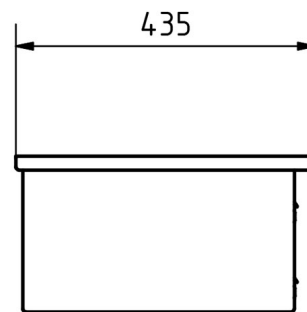
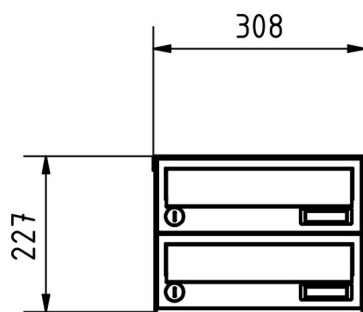

More images

