

BRENTANO® ST-R designer free-standing letterbox - RAL of your choice | ? Colour of your choice

Product number 803-RAL-STR



Product description

BRENTANO® ST-R designer free-standing letterbox with newspaper compartment - RAL 7016 anthracite grey

The BRENTANO® letterbox with elegant round tube stand elements and invisible lock combines modern design with first-class functionality. Made from high-quality materials and powder-coated, it not only impresses as a stylish design element for your home, but also with its durability. The clear lines and careful workmanship make the BRENTANO® letterbox the ideal choice for the highest design demands. Thanks to its robust construction, it is particularly weather-resistant and guarantees reliable protection for your mail. Perfect for anyone who values a harmonious balance of design and function.

The generous dimensions of the BRENTANO® design letterbox allow a capacity of approx. 20 litres, which means that even larger items such as DIN C4 envelopes or magazines can be accepted without creasing - even after several days of absence. Top-loading ensures convenient handling. The letterbox is also equipped with dampers that ensure the flap closes gently and quietly. The innovative push-key lock, which is concealed inside, allows the door to be opened without turning the key - simply insert the key into the opening and the door opens effortlessly. The clever arrangement of the lock and the removal door prevents the mail from falling towards you when opening. Manufactured from stainless steel and galvanised steel with an additional powder-coated finish, this letterbox is particularly durable and has a high-quality finish.

The unique one-hand operating concept with the push-key lock, available exclusively from Briefkasten Manufaktur Lippe, makes it particularly easy to use: you can open the letterbox, remove the post and close it again with just one hand. Protected by a utility model (DPMA file number DE: 20 2021 101 679.5), this innovation offers real added value.

Thanks to the design, self-assembly is uncomplicated.

- High-quality manufactured free-standing letterbox, powder-coated in RAL 7016 anthracite grey.
- Quality production - Made in Germany
- Innovative push-key lock including 2 keys with key number. Convenient locking without a key.
- Letterbox body made of 1.5 mm galvanised steel.
- Removal door made of 1.5 mm stainless steel V2A 1.4301 with opening limiter, can be opened from top to bottom. The retaining plate prevents the mail from falling towards you.
- Mail is inserted from the top and the flap is equipped with an opening limiter and high-quality dampers to ensure silent closing.
- The letterbox complies with DIN/EN 13724. Insertion size (3.5 cm x 36.0 cm) for C4 landscape, even large letters fit in here without creasing.
- Optional newspaper compartment on the back (WD 400x200x50mm) made of stainless steel, powder-coated. Open on both sides.
- Includes self-adhesive and engravable name plate.
- Optional name lettering approx. 20-30mm high.
- Optional house number lettering approx. 80-100mm high.
- The pedestals are made of 60.3 mm stainless steel V2A 1.4301, polished for screw mounting or setting in concrete.

Important information:

To achieve optimum water protection for your mail, the letterbox or letterbox system should be located under a canopy if possible.

The mail is only protected from water if it is completely placed in the box and the flap is closed. Mail that is not fully inserted allows moisture and dirt to enter the letterbox. This system is protected against the ingress of water in accordance with DIN EN 13724. Water ingress is not a reason for complaint.

Product properties

Material	Steel, galvanised, Stainless steel V2A 1.4301
Surface/colour	RAL 9005 deep black, RAL 3004 crimson red, DB 703 iron mica, RAL 7016 anthracite grey, RAL of your choice (according to colour table), Brushed, RAL 9007 grey aluminium, RAL 9016 traffic white
Series	BRENTANO
Functions	Newspaper compartment
Mounting type	Free-standing
House number	House number as laser engraving
Name labelling	Laser-engraved
Removal of mail	On the front
Number of boxes	with 1 letterbox
Boxes by volume	Large > 16 litres

Dimensions

Height of single box in mm	400,0
Width of single box in mm	400,0
Capacity in litres	19,5
Height of letterbox slot in mm	35,0
Width of letter slot in mm	360,0
Overall height in mm	1200,0 1500,0 1700,0
Total width in mm	570,0
Depth in mm	125.0 + 50.0 Optional newspaper compartment
Weight in kg	21
Delivery condition	Supplied in blocks, stand elements / letterbox divided

Drawing

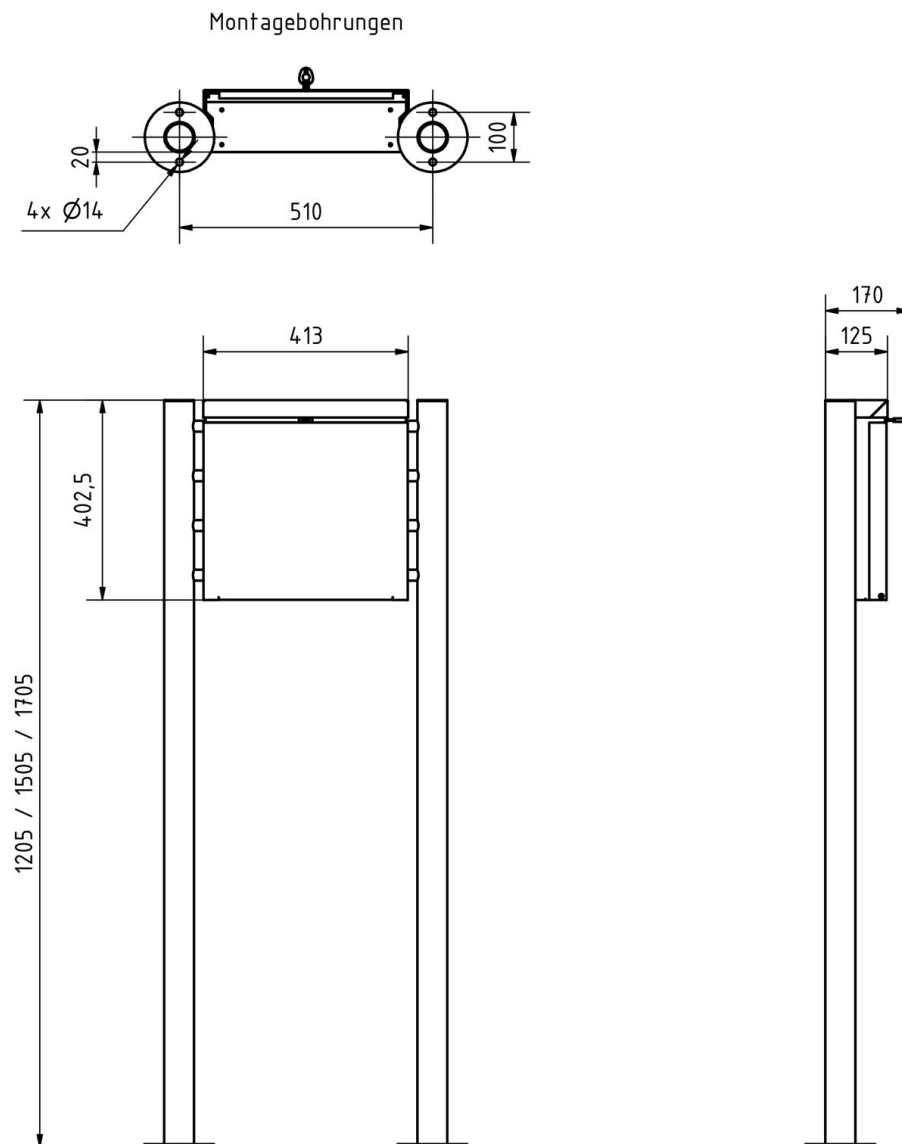

More images

