

1-post letterbox Design BASIC Plus 381X ST-R with bell box & newspaper compartment - stainless steel V2A | with 1 letterbox | Stainless steel, ground

Product number 381X-VA-1-SP-ZF



Product description

BASIC Plus 381X ST-R free-standing letterbox with bell box for intercom & newspaper compartment - polished V2A stainless steel

Modern free-standing letterbox for 1 party - made in Germany by Briefkasten Manufaktur.

The complete letterbox system is made of weather-resistant stainless steel V2A 1.4301, polished. The very high-quality workmanship and the well thought-out concept make this free-standing letter box our top seller. A rain drainage edge for optimum water protection, a continuous rubber lip for quiet insertion, the solid interchangeable nameplate, a practical post holder and the very robust lock characterise this free-standing letterbox. The side panelling with protruding rain cover made of V2A stainless steel offers optimum protection against the weather and guarantees a very long service life.

The letterbox systems in the BASIC Plus collection are characterised by the consistent use of V2A stainless steel. The result is a very long service life and sustainability. The design has been developed by our own engineers with a view to high flexibility and modularity, simple spare parts assembly and uncomplicated self-assembly. Spare parts are directly available for all BASIC Plus systems.

- **1-post letterbox made of V2A stainless steel, polished**
- The system is manufactured by Briefkasten Manufaktur. German quality production "Made in Germany".
- The letter box complies with DIN/EN 13724. Insertion size (3.5 cm x 32.5 cm) for C4 landscape, large letters also fit in here without creasing.
- Insertion flap with sound-absorbing rubber seal for very quiet insertion of mail.
- The door can be opened from left to right.
- Incl. 2 keys with key number, interchangeable nameplate (type 2) under the flap and post holder.
- Large capacity thanks to optional letterbox depth +50 mm = approx. 17 litres. Suitable for companies and households with very high mail volumes.
- Incl. side panelling + rain cover made of V2A stainless steel, polished.
- Newspaper compartment, open on both sides, made of V2A stainless steel, polished. Dimensions: 355x100x100mm
- **Bell box made of V2A stainless steel, polished**
- Intercom hole with universal adapter. (Intercom system/ built-in loudspeaker not included in the scope of delivery). Also available without speech perforation.
- Universal adapter is suitable for all commercially available built-in loudspeakers (Siedle, Ritto, TCS, Busch-Jäger, Gira, Legrand Bticino, ELCOM, Auerswald, Comelit and many more).
- Round stainless steel bell push button type: Grothe Protact, max. 24 V AC/DC, 1.5 A, IP 54 (pressure force limitation).
- Anti-vandalism - The nameplate is indentation-proof and impact-resistant, the plastic is flame-retardant.
- Cable access: Ø 10.4 mm (on the right side). Invisible cable routing through the stand element.
- The stand elements are made of 42.4 mm V2A stainless steel 1.4301, polished for screw mounting or setting in concrete.

Important information

Camera or intercom preparation

The intercom systems must be connected by an electrician. Please contact your trusted electrician for planning, fitting and installation.

Water protection

The mail is only protected against moisture and dirt when it is fully inserted and the flap is closed. Under certain extreme weather conditions, water may still enter (up to 1ccm according to DIN EN 13724). This is not a reason for complaint.

Product properties

Series	BASIC
Number of bell push buttons	1 button, 2 buttons, 3 buttons
Functions	Newspaper compartment, Light button, Camera, Intercom
Functional box prepared for manufacturer	GIRA, Busch Jaeger, Siedle, STR Elektronik, ELCOM, TCS, Ritto, ALGO, Telegärtner, Auerswald, Legrand Bticino, Comelit
Boxes by volume	Normal > 10 litres
Name labelling	Nameplate
Mounting type	Free-standing
Material	Stainless steel V2A 1.4301
House number	House number as laser engraving
Removal of mail	On the front
Number of boxes	with 1 letterbox
Surface/colour	Brushed

Dimensions

Height of single box in mm	330,0
Width of single box in mm	355,0
Capacity in litres	12
Height of letterbox slot in mm	35,0
Width of letter slot in mm	325,0
Height of letterbox in mm	530,0
Width of letterbox system in mm	355,0
Overall height in mm	1200,0 1500,0
Total width in mm	535,0
Depth in mm	100,0
Weight in kg	21
Delivery condition	Supplied in blocks, stand elements / letterbox divided

Drawing

Montagebohrungen

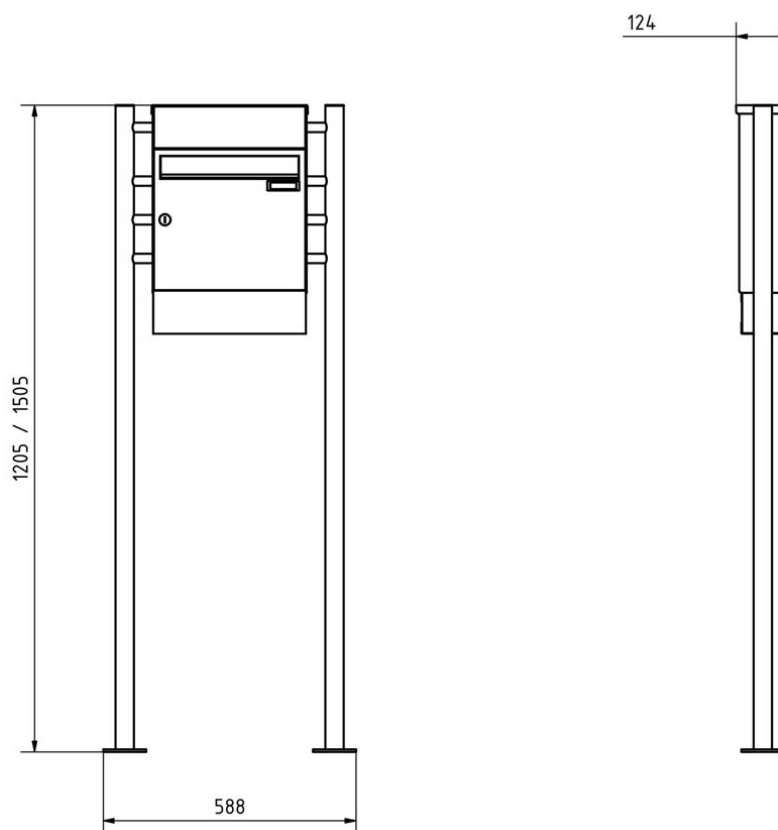
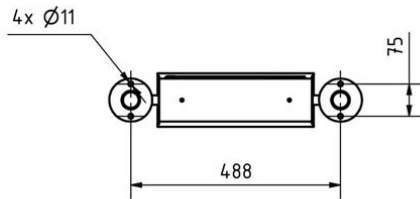

More images

