

Stainless steel waste bin - Waste bin design BASIC 650X ST-BP - 45 litres - RAL of your choice | ? Colour of your choice

Product number 650X-STBP-RAL

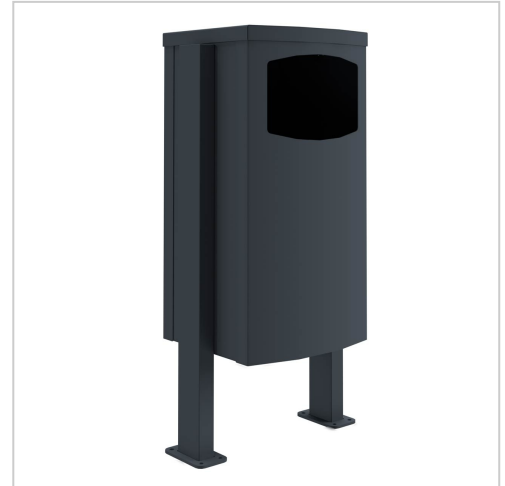

Product description

Stainless steel litter bin - Design BASIC 650X ST-BP litter bin - 45 litres - RAL of your choice

High-quality litter bin with elegant rectangular tube stand elements. The free-standing litter bin is made entirely of 2 mm stainless steel V2A 1.4301, powder-coated. This litter bin shines away from no comparison, extremely high-quality workmanship and precision.

The dimensions allow a capacity of approx. 45 litres and the opening guarantees that waste can be thrown in easily. Thanks to the sophisticated waste bag removal (see video), the litter bin is designed without visible screws and rivets.

Thanks to the design, self-assembly is uncomplicated.

- Litter bin - Litter bin made of stainless steel V2A 1.4301, 240 grain powder-coated in RAL/DB colour.
- The litter bin is manufactured by Briefkasten Manufaktur. German quality production "Made in Germany".
- Cover plate made of stainless steel V2A 1.4301, powder-coated in RAL/DB colour.
- Capacity of approx. 45 litres, the opening (270mm x 180mm) guarantees the convenient insertion of waste.
- Simple and easy replacement of the plastic sack: unlock and remove the cover plate, remove the front plate and replace the plastic sack.
- Water drainage corners in the base prevent water from collecting in the bin.
- Optional ashtray possible.
- The pedestals are made of 40x80mm stainless steel V2A 1.4301, powder-coated for screw mounting or setting in concrete.

Product properties

Surface/colour RAL 9005 deep black, RAL 3004 crimson red, DB 703 iron mica, RAL 7016 anthracite grey, RAL of your choice (according to colour table), RAL 9007 grey aluminium, RAL 9016 traffic white

Series BASIC

Mounting type Free-standing

Material Stainless steel V2A 1.4301

Dimensions

Capacity in litres	45
Overall height in mm	900,0 1200,0 + 30,0
Total width in mm	435,0
Depth in mm	380,0
Weight in kg	28
Delivery condition	Supplied in blocks, stand elements/carcass divided

Drawing

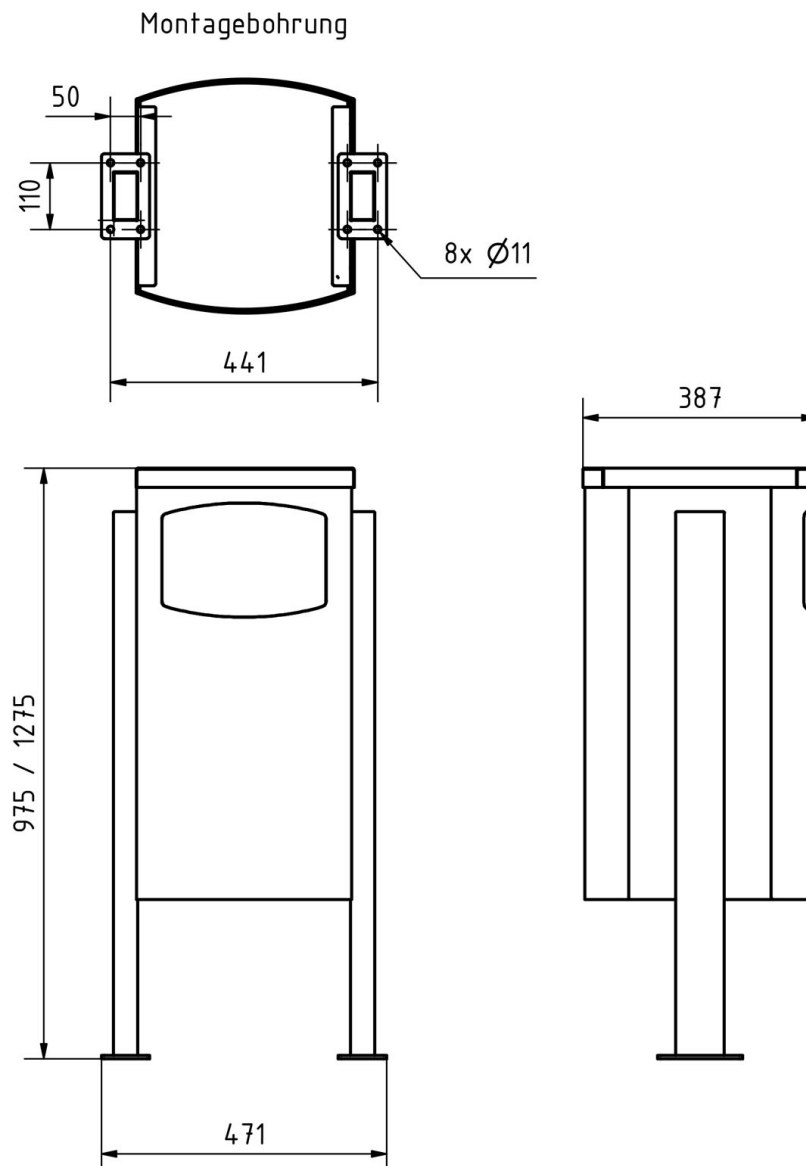

More images

