

CEE socket outlet pillar BASIC 372 for floor mounting - powder-coated stainless steel | CEE socket | 1-fold | ? Colour of your choice

Product number 372-VAR-CEE-1FACH

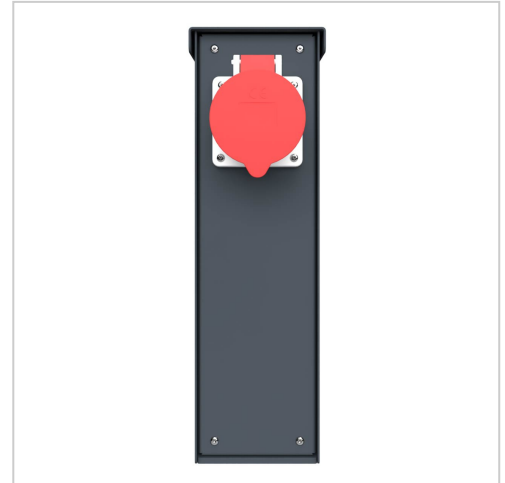

Product description

CEE socket outlet pillar BASIC 372 for floor mounting - powder-coated stainless steel

Modern socket pillar made entirely of V2A stainless steel, powder-coated in RAL/DB colour. Thanks to the side panelling and rain cover made of 2 mm stainless steel, as well as the IP44 CEE socket outlet, this socket outlet pillar is completely weatherproof and perfectly suited for outdoor use.

- Socket outlet pillar made entirely of V2A stainless steel.
- The socket pillar is manufactured by Briefkasten Manufaktur. German quality production "Made in Germany".
- Body and cover made of stainless steel V2A 1.4301, powder-coated in RAL/DB colour.
- Side cladding and rain cover made of 2mm stainless steel V2A 1.4301, powder-coated in RAL/DB colour.
- Surface-mounted socket outlet - CEE. Protection class IP 44 (splash water).
- Foot plate made of 5mm stainless steel for screw mounting.

Important information

Areas of application Camping sites, pitches and marinas

According to DIN VDE 0100-708 regulations, only up to a maximum of 4 sockets may be installed per power column.

Product properties

Surface/colour	RAL 9005 deep black, RAL 3004 crimson red, DB 703 iron mica, RAL 7016 anthracite grey, RAL of your choice (according to colour table), RAL 9007 grey aluminium, RAL 9016 traffic white
Series	BASIC
Charging connection	CEE, SCHUKO
Mounting type	Free-standing
Material	Stainless steel V2A 1.4301

Dimensions

Width in mm	112 182
Height in mm	362 337
Depth in mm	124.0 +64.0 Surface-mounted socket outlet CEE +54.0 Surface-mounted socket outlet Schuko
Weight in kg	6
Delivery condition	Supplied fully assembled

Drawing

Montagebohrungen

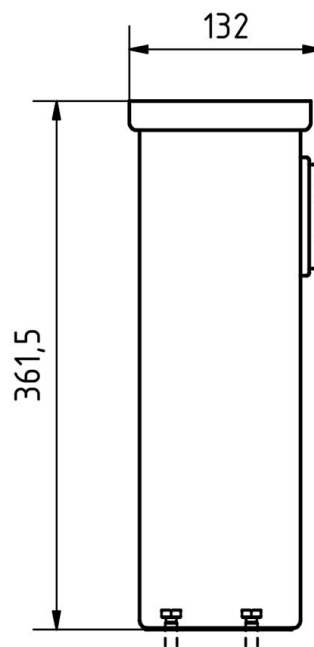
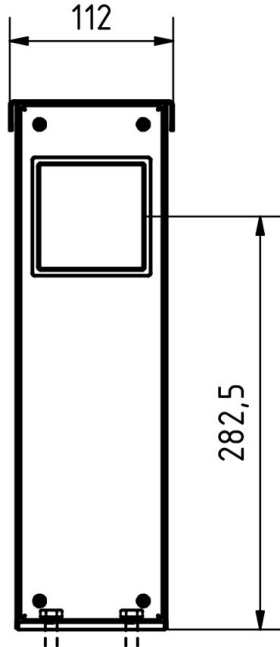
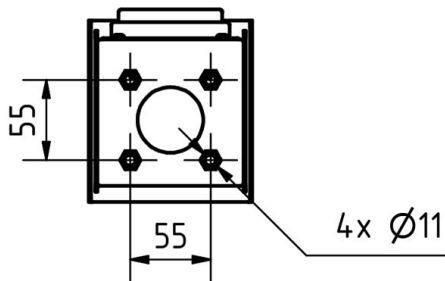

More images

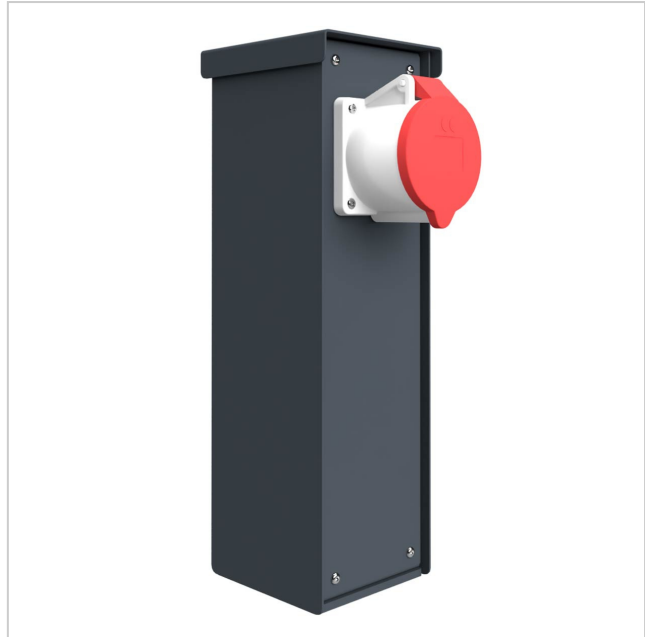
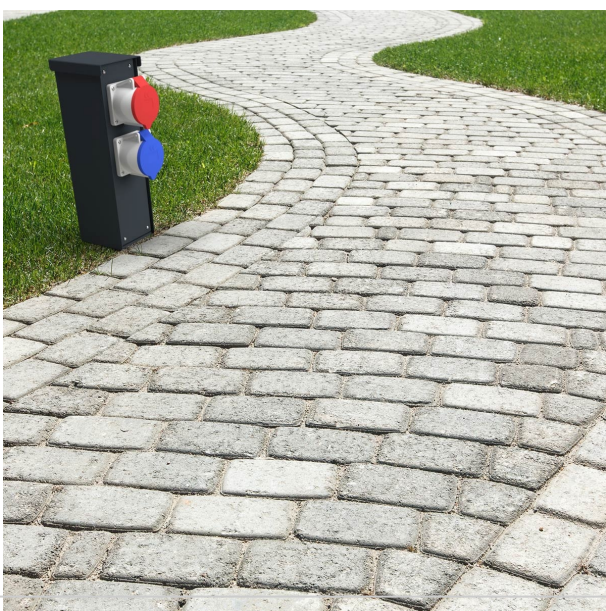

Montagebohrungen

