

# KANT free-standing letterbox with newspaper compartment - Avantgarde 1 design - RAL 7016 anthracite grey | RAL 7016 anthracite grey, fine structure, matt

**Product number** 303-A1-7016VA-STQ



## Product description

### KANT free-standing letterbox with newspaper compartment - Avantgarde 1 design - RAL 7016 anthracite grey

The KANT Avantgarde free-standing letterbox combines **elegant design** and functional convenience in one product. Its minimalist design with invisible lock and stylish labelling option fits seamlessly into modern living environments. You can rely on **long-lasting quality** thanks to our excellent choice of materials and precise workmanship.

The generous capacity of around 12 litres and top-loading ensures crease-free mail - even with DIN C4 envelopes and magazines. For added convenience, the letterbox is equipped with **high-quality axle dampers** that allow the flap to close gently and quietly. The newspaper compartment of this letter box offers maximum functionality with double-sided posting, ideal for modern everyday life. The scope of delivery includes a cover that can be retrofitted, giving you the option of reliably closing the weather side.

Thanks to the design, self-assembly is straightforward.

- High-quality, free-standing letterbox with letterbox made of galvanised steel, powder-coated in RAL 7016 anthracite grey fine structure matt.
- Design Avantgarde 1: 1x stainless steel panel, polished in 240 grit with street name and house number, 1x name plate, polished in 240 grit.
- The door can be opened from top to bottom.
- Insertion from above, insertion flap with high-quality axle dampers for silent closing.
- Includes 2 keys with key number.
- The letterbox complies with DIN/EN 13724. Insertion size (3.5 cm x 33.5 cm) for C4 landscape, large letters also fit in here without creasing.
- Newspaper compartment (BH 360x110mm), open on both sides (1x cover included).
- Optional name lettering approx. 8-25mm high.
- Optional street name approx. 8-25mm high.
- Optional house number lettering approx. 60-80mm high.
- The pillars are made of 40 mm x 40 mm stainless steel V2A 1.4301, polished for setting in concrete or screw mounting.

#### Important information:

To achieve optimum water protection for your mail, the letterbox or letterbox system should be located under a canopy if possible.

The mail is only protected from water if it is completely placed in the box and the flap is closed. Mail that is not fully inserted allows moisture and dirt to enter the letterbox. This system is protected against the ingress of water in accordance with DIN EN 13724. Water ingress is not a reason for complaint.

## Product properties

<b>Material</b>	Steel, galvanised, Stainless steel V2A 1.4301
<b>Series</b>	KANT
<b>Functions</b>	Newspaper compartment
<b>Boxes by volume</b>	Normal > 10 litres
<b>Mounting type</b>	Free-standing
<b>House number</b>	House number as laser engraving
<b>Surface/colour</b>	RAL 7016 anthracite grey, Brushed
<b>Name labelling</b>	Laser-engraved
<b>Removal of mail</b>	On the front
<b>Number of boxes</b>	with 1 letterbox

## Dimensions

<b>Height of single box in mm</b>	BK 280.0   ZF 110.0
<b>Width of single box in mm</b>	355,0
<b>Capacity in litres</b>	12
<b>Height of letterbox slot in mm</b>	35,0
<b>Width of letter slot in mm</b>	335,0
<b>Height of letterbox in mm</b>	412,0
<b>Width of letterbox system in mm</b>	372,0
<b>Overall height in mm</b>	1200,0   1500,0
<b>Depth in mm</b>	110.0 + 21.0 fascia + 40.0 stand elements
<b>Weight in kg</b>	14
<b>Delivery condition</b>	Supplied in blocks, stand elements / letterbox divided

## Drawing

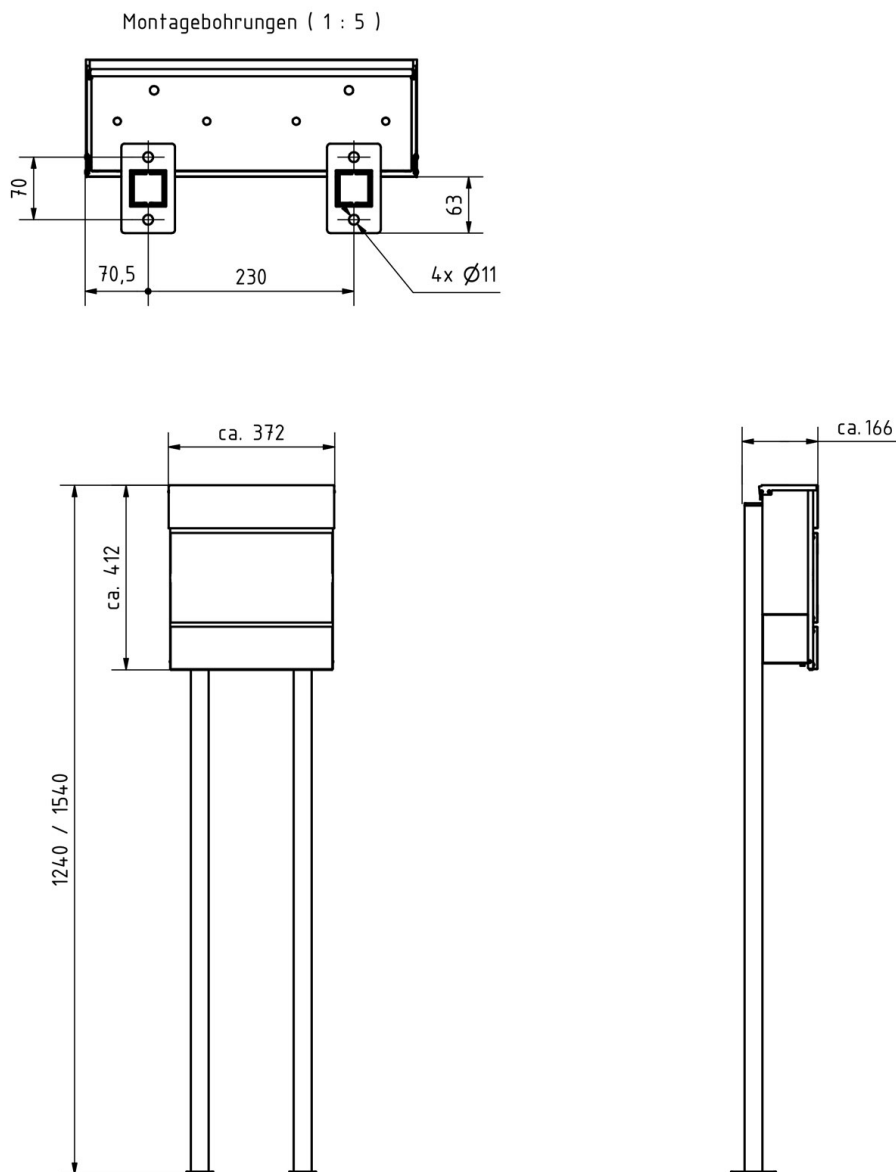

## More images

