

PREMIUM wall light 260x260 powder-coated | without motion detector

Product number 626R



Product description

PREMIUM 260x260 powder-coated wall light

Discover our premium stainless steel outdoor light in your choice of RAL colour and opal glass that is both aesthetically pleasing and functional. The outdoor light is made of high-quality stainless steel, which offers excellent resistance to the elements. The opal glass ensures a pleasant light distribution and adds a stylish touch to your outdoor area. The timeless design fits perfectly with various architectural styles and gives your home an elegant atmosphere. The separate mounting plate made of cast aluminium not only provides additional stability, but also makes the light particularly weatherproof. With an IP44 protection rating and protection class I, the light is ideally suited for outdoor use and withstands rain, dust and other environmental influences. The outdoor light is equipped with an E27 base and can be operated with bulbs in energy classes A++ to E with a maximum output of 57 W. This gives you the freedom to choose the desired brightness and energy efficiency. Please note that the light source is not included in the scope of delivery.

The outdoor light is supplied with a practical mounting plate made of cast aluminium, which enables simple and secure mounting. With our mounting accessories, installation is a breeze and you can quickly attach the light to your desired location.

- The outdoor light is made of stainless steel with opal glass, with separate mounting plate made of cast aluminium, powder-coated in RAL of your choice.
- Base E 27, suitable for lamps of energy classes A++ to E max. 57 W.
- Without light source.
- Protection class IP 44 - protection class I
- With cast aluminium mounting plate for fixing.
- Manufactured by Gebrüder Albert GmbH & Co KG Leuchtenfabrik - Quality Made in Germany (Fröndenberg).

Installation:

The national and international electronic safety regulations must be observed for the installation and operation of this light. Use the four grub screws to remove the wall plate from the luminaire fitting. Feed the mains cable connection through the cable grommet and fix the wall plate to the mounting surface. Push the enclosed silicone tubes over the connecting wires. Establish the protective conductor connection and electrical connection at the terminal. Tighten the light fitting and glass to the wall plate using the grub screws.

Product properties

Surface/colour	RAL 9005 deep black, DB 703 iron mica, RAL 7016 anthracite grey, RAL of your choice (according to colour table), RAL 9007 grey aluminium, RAL 9016 traffic white
Protection type	IP44
Illuminants	ohne
Material	Aluminium AlMg3 W19, Stainless steel V2A 1.4301
Protection class	I

Dimensions

Width in mm	260
Height in mm	260
Depth in mm	100,0
Delivery condition	Supplied fully assembled

Drawing

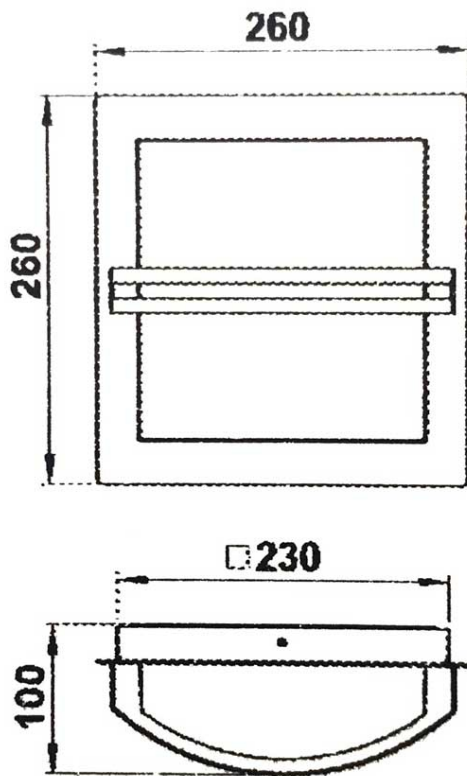

Wandschild

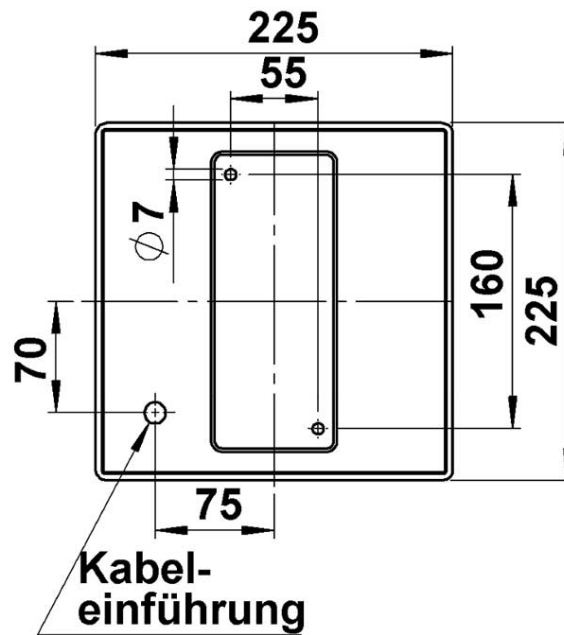

Wandschild kann gedreht werden!

More images

