

# Design flush-mounted letterbox GRIMM - polished stainless steel with preparation for camera and intercom on the right | Right | Individual preparation | Stainless steel, ground | Flush-mounted

**Product number** 562-UP-SPR-1-VA-IND

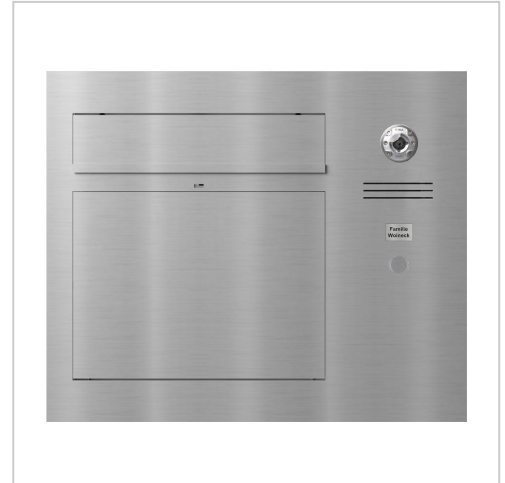

## Product description

### Design letterbox GRIMM® - A masterpiece of letterbox manufacturing

The GRIMM flush-mounted designer letterbox combines modern design with first-class workmanship - ideal for discerning clients and architects who are looking for an elegant solution for integrating a camera and built-in loudspeaker. Manufactured from high-quality stainless steel and completely "Made in Germany" by the letterbox manufacturer Lippe, this model stands for durability, functionality and a stylish look. The polished front panel made of 2 mm stainless steel V2A (#####\_0\_\_) impresses with its timeless appearance and high corrosion resistance.

Compatible with common manufacturers: LOXONE, Siedle, Busch-Jaeger, Gira, TCS, Legrand BTicino, Ritto, STR Elektronik, ELCOM, HHG, Comelit, Mobotix, HIKVISION and many others available on request.

The **preparation for a camera** (not included in the scope of delivery) provides a secure basis for modern video surveillance directly at the building entrance. **Preparation for built-in loudspeakers** is also possible - on request with a suitable universal adapter for various intercom stations. This allows the letterbox to be perfectly adapted to your existing technology.

The GRIMM® letterbox is not only a visual highlight, it is also at the forefront in terms of functionality and quality. Thanks to the innovative push-key lock, the letterbox can be operated easily and conveniently with one hand. Open the door with one push and close the door without using a key. The lock is optimally protected from the weather. The letterbox also features an intelligent removal system: the door opens from top to bottom, ensuring that the mail remains securely in the box and cannot fall towards you. Mail is also conveniently inserted from the front, with high-quality axle dampers ensuring that the flap closes gently. The GRIMM is particularly unique thanks to its double box system: the flush-mounted box can be installed during the shell construction phase, while the front panel is only fitted once the construction work has been completed - for maximum flexibility in the future and protection from dirt and dust during the construction phase. The plaster box is made of stainless steel and has pre-punched cable inlets on all sides to allow easy electrical installation.

Thanks to the DIN/EN 13724 standard, the GRIMM is ideal for large letters in C4 format, which can be inserted without creasing. The GRIMM® letterbox impresses with its durable quality, timeless design and sophisticated functionality.

- High-quality letterbox made entirely of stainless steel for flush mounting.
- Front panel made of 2 mm stainless steel V2A 1.4301, polished.
- Quality production - Made in Germany by Briefkasten Manufaktur Lippe.
- Preparation (built-in loudspeaker not included) for intercom system possible. Optionally with universal adapter for all commercially available built-in loudspeakers.
- Optional preparation (camera not included) for a camera.
- House number approx. 70mm high (max. 3 digits) with energy-saving LED lighting 12V DC approx. 50mA / 1W, white.
- Optional replaceable stainless steel nameplate with laser inscription or Plexi nameplate.
- 8-12V DC short-stroke bell push with LED ring lighting (blue, white, red or green). The bell button lighting cannot be supplied via the control unit. It must be connected to an additional 8-12 V DC power supply.
- An 8-12 V DC short-stroke light button with pictogram is available as an option.
- Incl. EVN LED power supply unit / transformer IP65 12V/DC 0.1-4W for the LED lighting (house number, bell push and nameplate if selected).
- Innovative push-key lock including 2 keys with key number, convenient locking without key, optimally protected from the weather.
- The removal door with opening limiter opens from top to bottom to prevent mail from falling towards you.
- Front mail slot with high-quality axle dampers for very quiet mail insertion.
- DIN/EN 13724-compliant letterbox, insertion size (3.5 cm x 32.5 cm) for C4 landscape - even large letters remain intact. Additional stainless steel removal protection integrated.
- Optimum weather protection thanks to offset cover.
- Double box system: Ideal for flush mounting. The cover can be easily installed once the construction work is complete.
- Plaster box made of stainless steel ##### (stainless, magnetic stainless steel) with pre-punched cable inlets on all sides.

#### Important information:

To achieve optimum water protection for your mail, the letterbox or letterbox system should be located under a canopy if possible.

The mail is only protected from water if it is completely placed in the box and the flap is closed. Mail that is not fully inserted allows moisture and dirt to enter the letterbox. This system is protected against the ingress of water in accordance with DIN EN 13724. Water ingress is not a reason for complaint.

## Product properties

<b>Series</b>	GRIMM
<b>Number of bell push buttons</b>	1 button
<b>Functions</b>	Light button, Camera, Intercom, Fingerprint, Keypad
<b>Functional box prepared for manufacturer</b>	LOXONE, GIRA, Busch Jaeger, Siedle, STR Elektronik, ELCOM, TCS, Ritto, ALGO, Telegärtner, Auerswald, Legrand Bticino, HHG, HIKVISION, PCS, Sesam, ekey, Comelit, Schneider Intercom / COMMEND, Mobotix
<b>Name labelling</b>	Laser-cut engraving, Nameplate, Laser-engraved , Illuminated laser-cut engraving
<b>Material</b>	Stainless steel V2A 1.4301, Stainless steel 1.4016 (non-rusting magnetic stainless steel)
<b>House number</b>	House number as laser engraving, House number as laser cut, illuminated
<b>Removal of mail</b>	On the front
<b>Number of boxes</b>	with 1 letterbox
<b>Surface/colour</b>	Brushed
<b>Boxes by volume</b>	Large > 16 litres
<b>Mounting type</b>	Flush-mounted

## Dimensions

Height of single box in mm	460,0
Width of single box in mm	560,0
Capacity in litres	26,0
Height of letterbox slot in mm	35,0
Width of letter slot in mm	325,0
Height of letterbox in mm	External dimension 500.0   installation dimension 460.0
Width of letterbox system in mm	External dimension 600.0   installation dimension 560.0
Depth in mm	150,0
Weight in kg	19
Delivery condition	Delivery is assembled

## Drawing

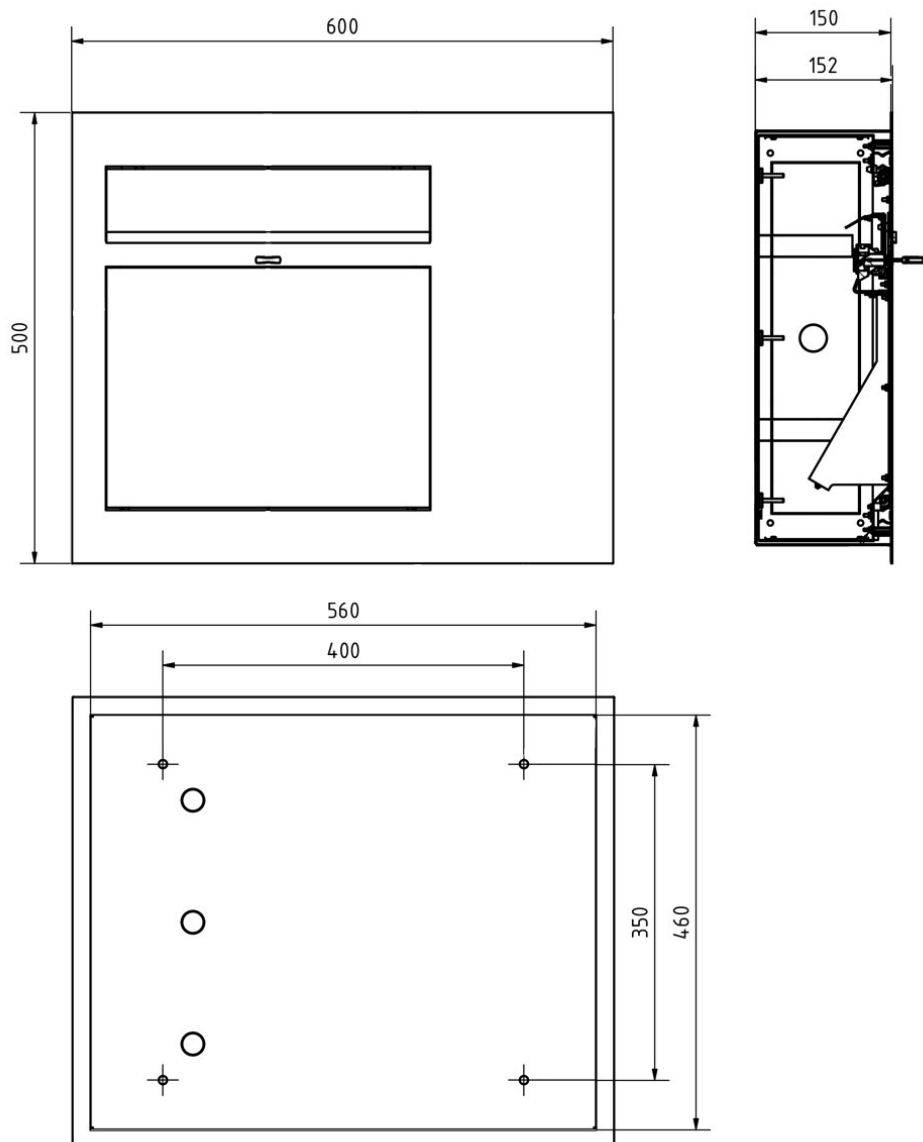

## More images

