

# 6er 2x3 stainless steel free-standing letterbox Design BASIC Plus 385X ST-R - 220mm - RAL of your choice | with 6 letterboxes (3x2) | ? Colour of your choice | 300x220x385 mm (WxHxD) - ??? Large 25 litres

**Product number** 385XR220-6W



## Product description

### 6er 2x3 stainless steel letterbox Design BASIC Plus 385X ST-R - 220mm - RAL of your choice

Modern free-standing letterbox for 6 parties made in Germany by Briefkasten Manufaktur.

The large letterboxes with a volume of 25 litres are made of stainless steel V2A, powder-coated in RAL colour, the stand elements are made of weather-resistant stainless steel V2A, polished. The very high-quality workmanship and the well thought-out concept make this letterbox system our top seller. A rain drainage edge for optimum water protection, a throw-in flap with rubber lip, the solid interchangeable nameplate and the robust lock characterise this free-standing letterbox. This letterbox is easy to clean and robust.

The letterbox systems in the BASIC Plus collection are characterised by the consistent use of V2A stainless steel. The result is a very long service life and sustainability. The design has been developed by our own engineers with a view to high flexibility and modularity, simple spare parts assembly and uncomplicated self-assembly. Spare parts are directly available for all BASIC Plus systems.

- **6-post letterbox made of V2A stainless steel, powder-coated in RAL colour**
- The system is manufactured by Briefkasten Manufaktur. German quality production "Made in Germany".
- The letterboxes comply with DIN/EN 13724. Insertion size (3.5 cm x 26.5 cm) for C4 high, large letters also fit in here without creasing.
- Insertion flaps with sound-absorbing rubber lip for very quiet insertion of mail.
- The doors can be opened from left to right.
- Incl. 2 keys with key number and changeable name plate under the flap for each letterbox.
- With close-fitting side panelling and rain cover in solid design.
- The stand elements are made of 60.0 mm V2A stainless steel 1.4301, polished for screw mounting or setting in concrete.

#### Important information:

The post is only protected from moisture and dirt when it is fully inserted and the flap is closed. Under certain extreme weather conditions, water can still get in (up to 1ccm according to DIN EN 13724). This is not a reason for complaint.

## Product properties

<b>Surface/colour</b>	RAL 9005 deep black, RAL 3004 crimson red, DB 703 iron mica, RAL 7016 anthracite grey, RAL of your choice (according to colour table), Brushed, RAL 9007 grey aluminium, RAL 9016 traffic white
<b>Series</b>	BASIC
<b>Number of boxes</b>	with 6 letterboxes
<b>Name labelling</b>	Nameplate
<b>Mounting type</b>	Free-standing
<b>Material</b>	Stainless steel V2A 1.4301
<b>Removal of mail</b>	On the front
<b>Boxes by volume</b>	Large > 16 litres

## Dimensions

<b>Height of single box in mm</b>	220,0
<b>Width of single box in mm</b>	300,0
<b>Capacity in litres</b>	25
<b>Height of letterbox slot in mm</b>	35,0
<b>Width of letter slot in mm</b>	265,0
<b>Height of letterbox in mm</b>	440,0
<b>Width of letterbox system in mm</b>	900,0
<b>Overall height in mm</b>	1200,0   1500,0   1700,0
<b>Total width in mm</b>	1065,0
<b>Depth in mm</b>	435,0
<b>Weight in kg</b>	34
<b>Delivery condition</b>	Supplied in blocks, stand elements / letterbox divided

## Drawing

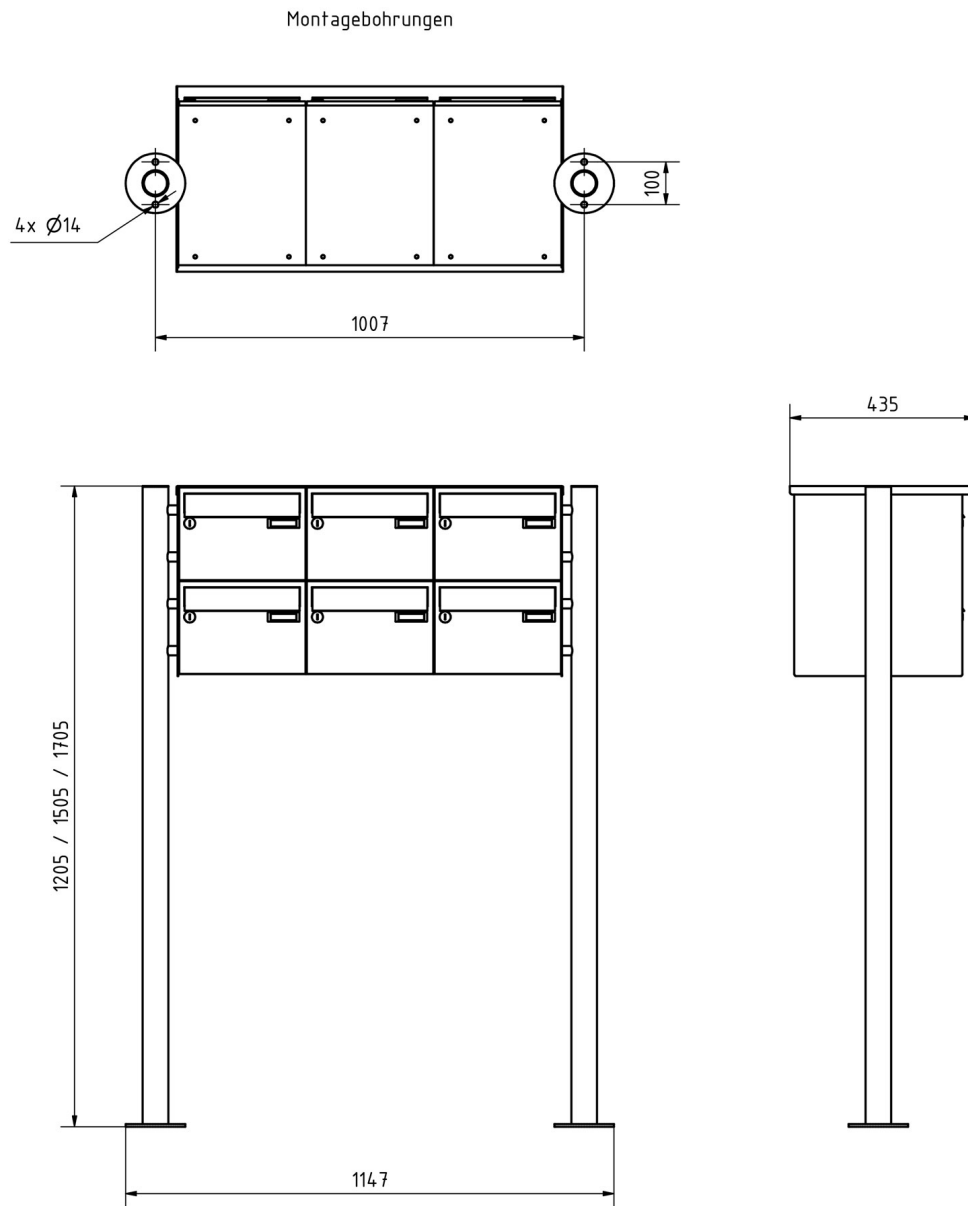

## More images

