

Surface-mounted parcel box KANT Edition - Design Elegance 4 - RAL 9016 traffic white | RAL 9016 traffic white fine structure matt

Product number 303-PK-E4-9016VA-AP



Product description

KANT Edition surface-mounted parcel box with lock technology - Elegance 1 design - RAL 9016 traffic white

The KANT Edition parcel box is an innovative solution that combines **elegant design** and functional convenience. With its minimalist design, which features an invisible lock and stylish labelling options, it blends seamlessly into modern living environments. You can rely on **long-lasting quality** thanks to our excellent choice of materials and precise workmanship.

The generous opening allows parcels up to a size of 360 x 250 x 130 mm to be posted, meaning that parcels up to parcel size M can also be posted securely and without any problems. A special highlight is the protective flap, which not only elegantly covers the opening but also the lock and protects it from moisture. Thanks to the integrated lock technology, parcels can only be removed from the bottom of the lock-secured compartment, preventing theft from above. A parcel box for the simple receipt of parcels, parcel receipt independent of the deliverer! Any parcel delivery company (e.g. DHL, DPD, TNT, GLS, Hermes, etc.) can use this parcel box. Thanks to the airlock technology and 85 litre capacity, it is possible to receive several parcels. For daily post, we recommend the KANT letter box in a matching design.

Self-assembly is straightforward thanks to the sophisticated design.

- High-quality surface-mounted parcel box made of galvanised steel, powder-coated in RAL 9016 traffic white fine structure matt.
- Elegance 4 design: stainless steel trim, 240 grit polished.
- Parcel compartment volume: approx. 85 litres, max. Parcel size: 360 x 250 x 130 mm (WHT), which corresponds to parcel size M.
- Large insertion flap with airlock technology for multiple parcel loading.
- Drop-in flap with damping for quiet closing.
- The door can be opened from top to bottom.
- Includes 2 keys with key number.
- Optional name labelling approx. 8-25 mm high.
- Optional house number labelling approx. 100-120mm high.
- For surface wall mounting including mounting screws.

Important information:

To achieve optimum water protection for your parcels, the parcel box or parcel box system should be located under a canopy if possible.

The parcel is only protected from water if it is completely placed in the box and the flap is closed. Parcels that are not fully inserted allow moisture and dirt to enter the parcel box. Water ingress is not a reason for complaint.

Product properties

Material	Steel, galvanised, Stainless steel V2A 1.4301
Series	KANT
Functions	Newspaper compartment, Parcel compartment
Number of boxes	with 1 parcel box, with 1 letterbox
House number	House number as laser engraving
Name labelling	Laser-engraved
Removal of mail	On the front
Boxes by volume	Jumbo > 30 litres
Surface/colour	Brushed, RAL 9016 traffic white
Mounting type	Surface-mounted

Dimensions

Height of single box in mm	580,0
Width of single box in mm	440,0
Capacity in litres	85
Depth in mm	350,0
Weight in kg	18
Delivery condition	Supplied fully assembled

Drawing

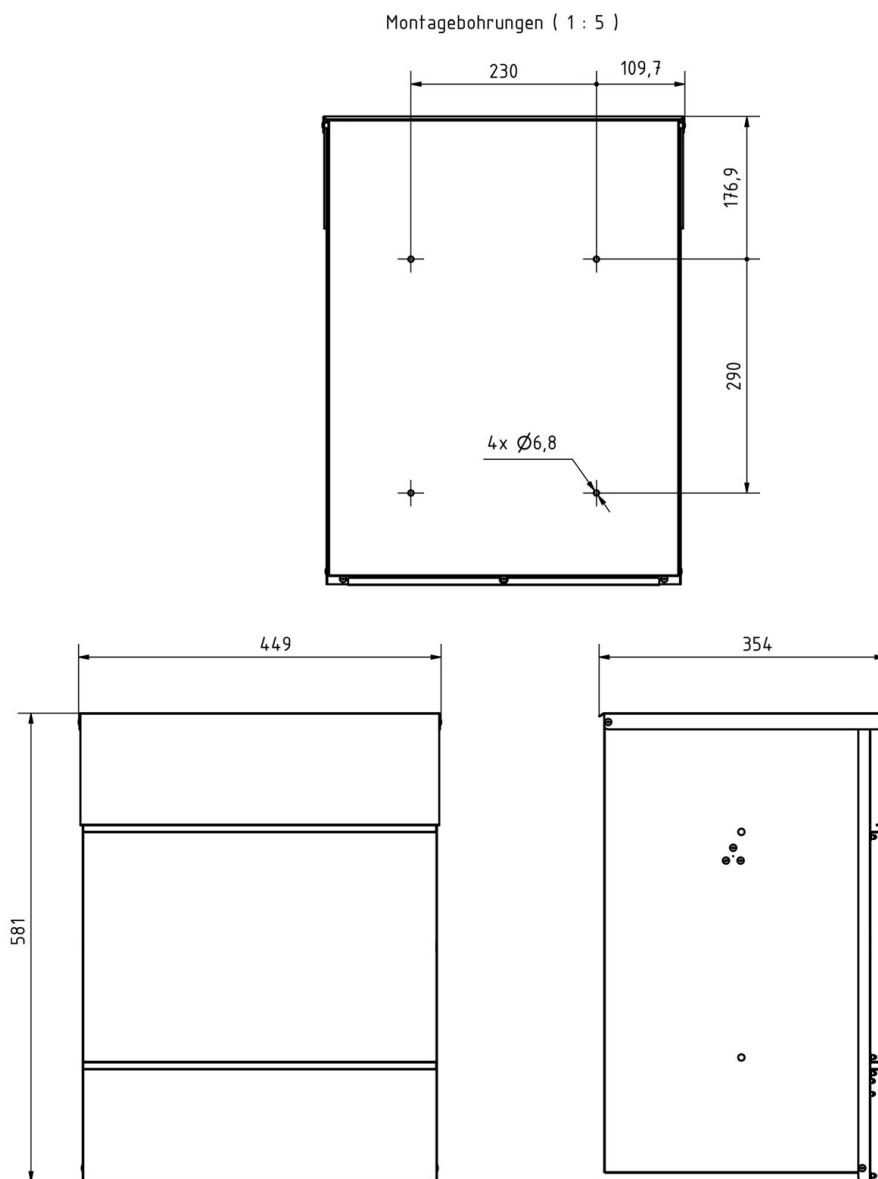

More images

