

Waste bin box BOXsystem BASIC 751V2 - RAL of your choice - 120-240 litres | without letterbox | Door hinge left * Lock right

Product number 751V2-1-VAR-0BK-SR



Product description

Modular waste bin box BASIC 751V1 - RAL of your choice - 120-240 litres

High-quality modular waste bin box with square tube stand elements made entirely of stainless steel, powder-coated. This bin box impresses with its extremely long service life and solid construction - made in Germany.

If you are looking for an elegant solution for storing waste bins near a property, then this stainless steel waste bin box is the answer. Whether in the garden, on the driveway or in the yard - the unattractive bins disappear in a bin enclosure. The closed panelling conceals the waste bins placed behind it. The actual purpose of the bin box is not visible, as the bin box blends harmoniously into the overall architecture when used with other architectural elements (fence, letterbox, house number, etc.) from Briefkasten Manufaktur. The waste bin enclosure is suitable for all standard household waste bin sizes (120-240 litres).

This waste bin enclosure is also available as a parcel compartment with a parcel lock. Please ask us about this.

- Bin box made of stainless steel 1.4016 (rustproof magnetic stainless steel), powder-coated in RAL colour of your choice.
- The waste bin box is handcrafted at Briefkasten Manufaktur. German quality production "Made in Germany".
- Door and side panels made of 1.5 mm stainless steel, powder-coated.
- High-quality handle shell with lock made of zamak / plastic.
- Rain canopy made of stainless steel, powder-coated. Optional planting roof possible.
- Interlinking of individual BOXsystem boxes possible.
- The uprights are made of 40x40 mm stainless steel V2A 1.4301, powder-coated for screw mounting.

Product properties

Surface/colour	RAL 9005 deep black, RAL 3004 crimson red, DB 703 iron mica, RAL 7016 anthracite grey, RAL of your choice (according to colour table), Brushed, RAL 9007 grey aluminium, RAL 9016 traffic white
Series	BASIC
Mounting type	Free-standing
Material	Stainless steel V2A 1.4301
Name labelling	Laser-engraved

Dimensions

Overall height in mm	1227.0 + 60.0 Optional planting roof
Total width in mm	830,0
Depth in mm	830,0
Weight in kg	45
Delivery condition	Supplied partially disassembled

Drawing

Montagebohrungen

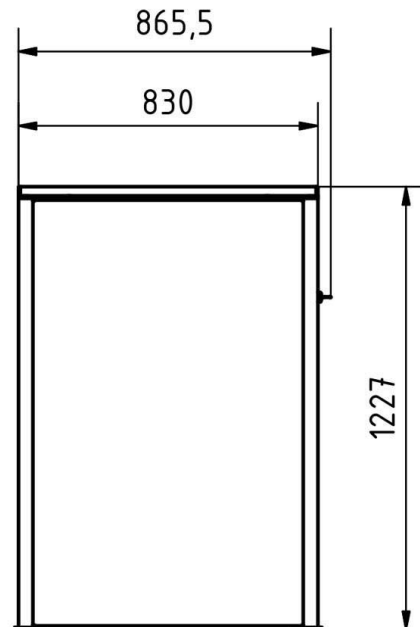
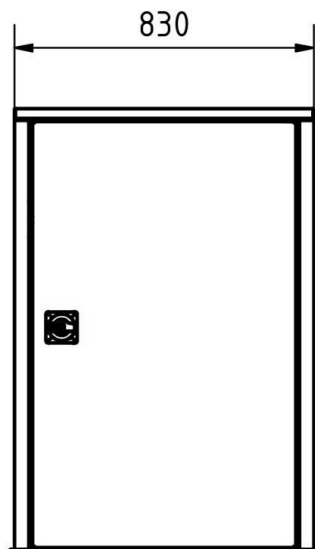
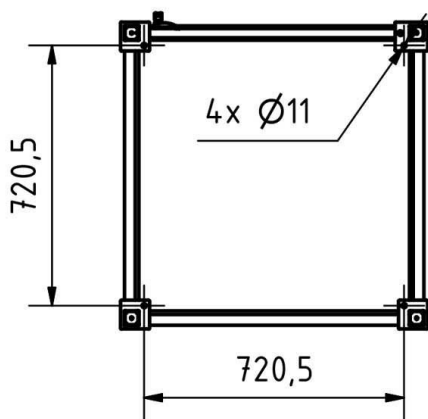

More images

